



**US Army Corps
of Engineers**

Vicksburg District
4155 Clay Street
Vicksburg, MS 39183-3435
www.mvk.usace.army.mil



Public Notice

APPLICATION NO.:	MVK-2018-233
EVALUATOR:	Ms. Kristi Hall
PHONE NO.:	(601) 631-7528
E-MAIL:	Kristina.W.Hall@usace.army.mil
DATE:	May 17, 2018
EXPIRATION DATE:	June 7, 2018

Interested parties are hereby notified that the U.S. Army Corps of Engineers, Vicksburg District, and the Arkansas Department of Environmental Quality, are considering an application for a Department of the Army permit and State water quality certification for the work described herein. Comments should be forwarded to the Vicksburg District, Attention: CEMVK-OD-F, at the above address, and the Arkansas Department of Environmental Quality, Post Office Box 8913, Little Rock, Arkansas 72219-8913, and must reach these offices by the cited expiration date.

Law Requiring a Permit: Section 404 of the Clean Water Act (33 U.S.C. 1344), which applies to discharges of dredged and / or fill material into waters of the United States.

Name of Applicant:
Mr. Tony Floyd
Benton Street Department
305 West Hazel Street
Benton, Arkansas 72015

Name of Agent:
Mr. Josh Fluger
GBMc & Associates
219 Brown Lane
Bryant, Arkansas 72022

Location of Work: Section 11, T2S- R15W, Latitude 34.5649, Longitude -92.5762, within the Depot Creek watershed part of the Upper Saline River Drainage Basin (8-digit USGS HUC 08040203), Saline County, Arkansas.

Description of Work: (See enclosed map and drawings.)

The following descriptions of the proposed project and associated impacts are based upon information provided by the applicant.

The applicant is applying for a Department of the Army permit to conduct regulated activities in jurisdictional wetlands for the purpose of stabilizing stream banks to prevent further erosion along 1,125 linear feet of an unnamed tributary

to Depot Creek. The purpose of the project is to replace collapsed retaining walls to stabilize the stream banks to prevent further erosion. Old concrete retaining walls that previously covered the northern end of the project have collapsed and have resulted in channel degradation in recent years. Bank sloughing, loss of property, and utility line exposure have all occurred as a result of failing stream banks. Work in jurisdictional areas will be related to construction of revetment gravity wall on the left and right stream banks along the entire reach and construction of in-stream grade control structures to reduce stream energy and maintain grade (prevent bed degradation, bed cutting). Approximately, 180 feet of channel would be straightened to reduce impacts to utility lines within the right-of-way. Mechanized equipment would be used to remove any remaining old failing structures and trees. Bank re-shaping and soil excavation would occur.

The applicant proposes to mitigate for the unavoidable loss of jurisdictional impacts through the purchase of credits from a commercial mitigation bank.

Upon reviewing this notice, you should write to this office to provide your opinion of the impacts this work will have on the natural and human environment and address any mitigation you believe is necessary to offset these impacts. Other comments are welcome, but the above information will further our review of the applicant's plan as proposed. Comments of a general nature are not as helpful as those specific to the impacts of the subject project.

State Water Quality Permit: The State Pollution Control Agency must certify that the described work will comply with the State's water quality standards and effluent limitations before a Corps permit is issued.

Cultural Resources: The Regulatory Archaeologist has reviewed the latest published version of the National Register of Historic Places, state lists of properties determined eligible, and other sources of information. The following is current knowledge of the presence or absence of historic properties and the effects of the proposed undertaking upon these properties: the permit area has been so extensively modified that little likelihood exists for the proposed project to impinge upon a historic property, even if present within the affected area.

Endangered Species: Our initial finding is that the proposed work may affect, but is not likely to adversely affect the following endangered species or their critical habitats: Arkansas fatmucket, Rabbitsfoot, Winged Mapleleaf.

Floodplain: In accordance with 44 CFR Part 60 (Floodplain Management and Use), participating communities are required to review all proposed development to determine if a floodplain development permit is required. Floodplain administrators should review the proposed development described in this public notice and apprise this office of any flood plain development permit

requirements. The project is completely located within the 100 year floodplain.

Evaluation Factors: The decision whether or not to issue a permit will be based upon an evaluation of the probable impact of the proposed activity on the public interest. That decision will reflect the national concern for both protection and utilization of important resources. The benefits which may be expected to accrue from the proposal must be balanced against its expected adverse effects. All factors which may be relevant to the proposal will be considered; among these are conservation, economics, aesthetics, general environmental concerns, historic values, fish and wildlife values, flood damage prevention, land use classification, navigation, recreation, water supply, water quality, energy needs, safety, food requirements and, in general, the needs and welfare of the people. Evaluation of the proposed activity will include application of the guidelines published by the Environmental Protection Agency under authority of Section 404(b) of the Clean Water Act.

Public Involvement: The purpose of this notice is to solicit comments from the public; Federal, State, and local agencies and officials; Indian Tribes; and other interested parties. These comments will be used to evaluate the impacts of this project. All comments will be considered and used to help determine whether to issue the permit, deny the permit, or issue the permit with conditions, and to help us determine the amount and type of mitigation necessary. This information will be used in our Environmental Assessment or Impact Statement. Comments are also used to determine the need for a public hearing.

Opportunity for a Public Hearing: Any person may make a written request for a public hearing to consider this permit application. This request must be submitted by the public notice expiration date and must clearly state why a hearing is necessary. Failure of any agency or individual to comment on this notice will be interpreted to mean that there is no objection to the proposed work. Please bring this announcement to the attention of anyone you know who might be interested in this matter.

Notification of Final Permit Actions: Each month, the final permit actions from the preceding month are published on the Vicksburg District Regulatory web page. To access this information, you may follow the link from the Regulatory web page, <http://www.mvk.usace.army.mil/Missions/Regulatory.aspx>.

Thomas A. McCabe
Thomas A. McCabe
Chief, Evaluation Section
Regulatory Branch



May 3, 2018
 MVK-2018-233
 Princeton & Monclair
 Drainage Improvements
 Section 11, T25S-R14W
 Benton, Saline County, Arkansas

Prepared by:
 Arel Simpson

**Preliminary
 Jurisdictional Determination**

**US Army Corps
 of Engineers.**

**Regulatory Branch
 Enforcement Section**

0 170 340
 Feet

Enclosure 1



Legend

- Intermittent Stream (1,278 L.F.)
- Intermittent Stream (909 L.F.)
- Proposed Excavation Work Area
- Proposed Revetment Area

There are jurisdictional waters of the U.S. within the proposed work areas. The discharge of dredged and/or fill material into a jurisdictional water will require a permit.

BENTON PRINCETON AND MONTCLAIR
DRAINAGE IMPROVEMENTS PHASE 2
SECTION 11
TOWNSHIP 2S
RANGE 15W
BENTON QUADRANGLE
SALINE COUNTY, ARKANSAS
LATITUDE: 34.56489°N
LONGITUDE: 92.57615°W

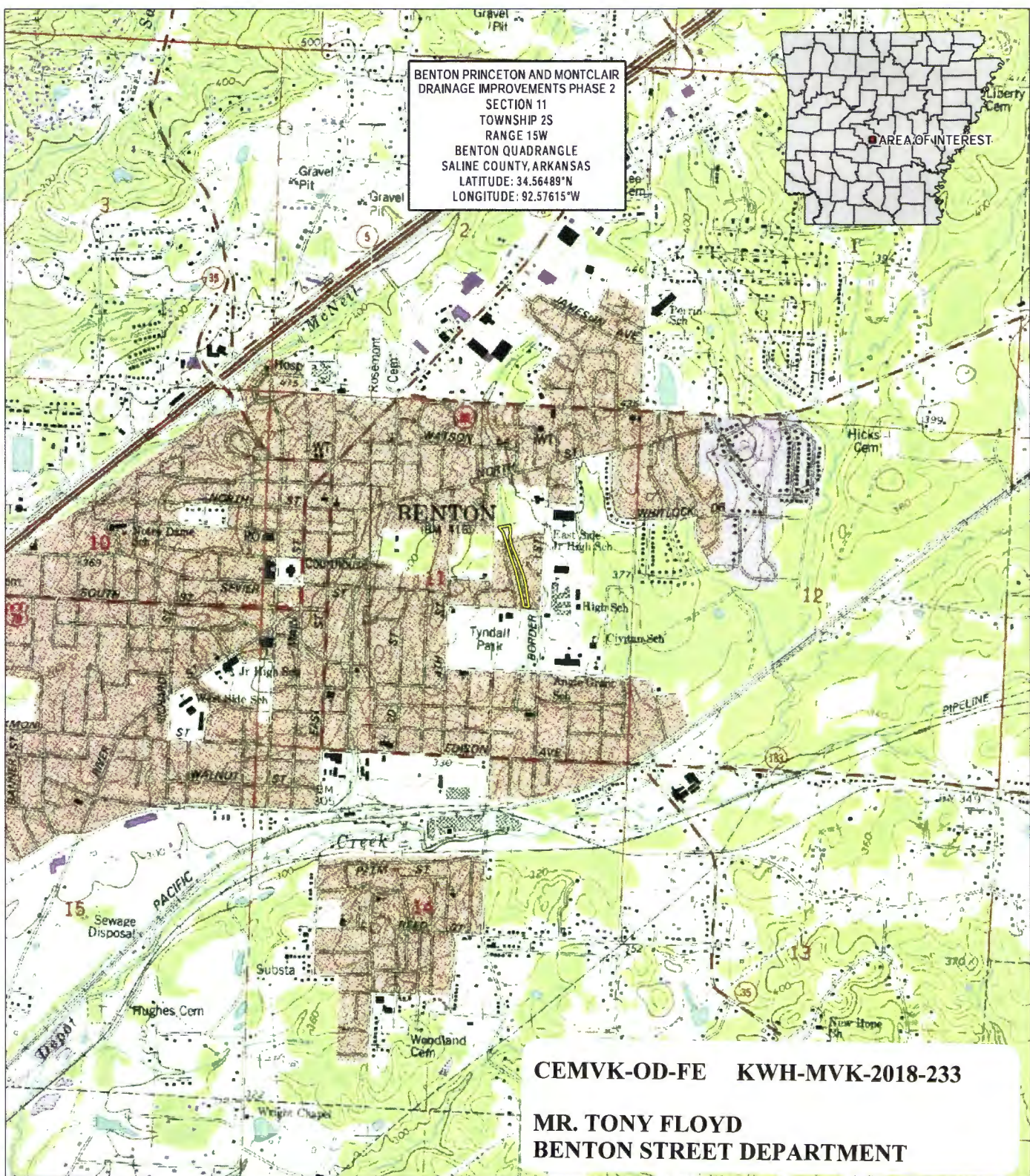

CEMVK-OD-FE KWH-MVK-2018-233
MR. TONY FLOYD
BENTON STREET DEPARTMENT



 PROJECT BOUNDARY

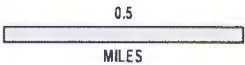

3850.000.G4

TOPOGRAPHIC
LOCATION MAP

MCCLELLAND CONSULTING ENGINEERS, INC.
BENTON, ARKANSAS

Approved by: JJF
Checked by: JJF
Drawn by: IT



Project No.: 3850-17-302
Date: 03/13/2018
Scale: SHOWN



BENTON PRINCETON AND MONTCLAIR
 DRAINAGE IMPROVEMENTS PHASE 2
 SECTION 11
 TOWNSHIP 2S
 RANGE 15W
 BENTON QUADRANGLE
 SALINE COUNTY, ARKANSAS
 LATITUDE: 34.56489°N
 LONGITUDE: 92.57615°W



CEMVK-OD-FE KWH-MVK-2018-233
MR. TONY FLOYD
BENTON STREET DEPARTMENT

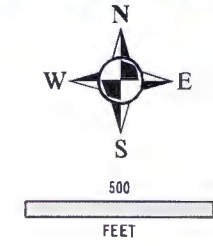

 PROJECT BOUNDARY

3850.000.G2	
AERIAL PHOTOGRAPHY	
MCLELLAND CONSULTING ENGINEERS, INC. BENTON, ARKANSAS	
Approved by: JJF	Project No.: 3850-17-302
Checked by: ENJ	Date: 03/13/2018
Drawn by: IT	Scale: SHOWN
	
<small>STRATEGIC ENVIRONMENTAL SERVICES 219 Brown Lane Benton, Arkansas 72022</small>	

PRINCETON AND MONTCLAIR DRAINAGE IMPROVEMENTS PHASE II BENTON, ARKANSAS

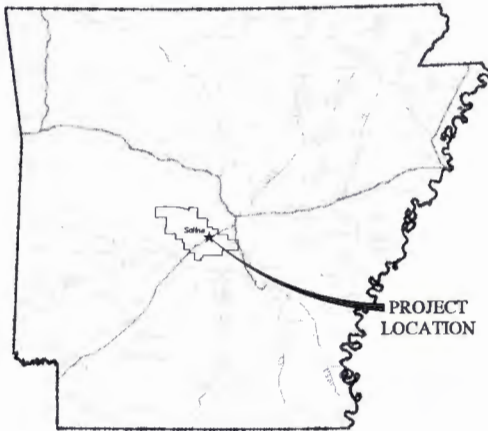

LOCATION MAP

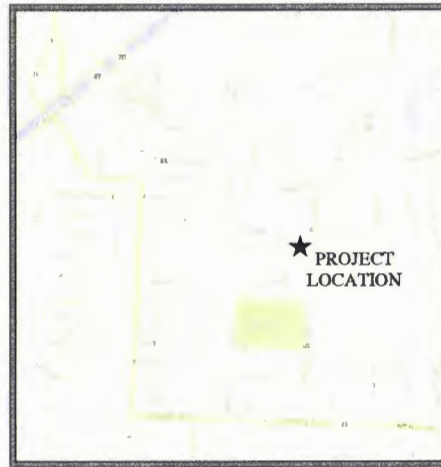

VICINITY MAP

INDEX TO DRAWINGS

1. COVER SHEET
2. PROJECT OVERVIEW
3. TOPOGRAPHIC SURVEY
4. TOPOGRAPHIC SURVEY
5. TOPOGRAPHIC SURVEY
6. TOPOGRAPHIC SURVEY
7. TYPICAL SECTIONS OF IMPROVEMENT
8. DRAINAGE PLAN AND PROFILE
9. DRAINAGE PLAN AND PROFILE
10. DRAINAGE PLAN AND PROFILE
11. DRAINAGE PLAN AND PROFILE
12. DRAINAGE PLAN AND PROFILE
13. DRAINAGE PLAN AND PROFILE
14. DRAINAGE PLAN AND PROFILE
15. DRAINAGE PLAN AND PROFILE
16. CROSS SECTIONS
17. CROSS SECTIONS
18. CROSS SECTIONS
19. CROSS SECTIONS
20. CROSS SECTIONS
21. CROSS SECTIONS

MARCH, 2018
MCE PROJECT NO. LR17-5768

MCE McCLELLAND
DESIGNED TO SURVIVE CONSULTING
ENGINEERS, INC.

1810 N. College Fayetteville, AR 72702 PHN 479-443-2377
7302 Kanis Rd. Little Rock, AR 72204 PHN 501-371-0272
4605 S. Garnett Rd. Ste. 401 Tulsa, OK 74146 PHN 918-619-6803

<http://www.mce.us.com>



ORIGINAL SIGNATURE ON FILE

PRINCETON AND MONTCLAIR DRAINAGE IMPROVEMENTS PHASE II - BENTON, ARKANSAS LR17-5768, JANUARY 2018

CEMVK-OD-FE KWH-MVK-2018-233

MR. TONY FLOYD
BENTON STREET DEPARTMENT

W:\2017\17-5768 Benton Princeton and Montclair Drainage Improvements - Boundary Survey Only\Change Drawings\COVER.dwg, 3/8/18, 4:34pm

- SPECIAL NOTES:**
1. ALL WORK SHALL BE ACCORDING TO THE SPECIFICATIONS AND SPECIAL CONDITIONS TO BE PROVIDED BY THE CITY OF BENTON.
 2. THE LOCATION OF ANY EXISTING UTILITIES, PIPES, POLES, GAS, PHONE, ETC. ARE SHOWN ON THE PLAN. THE CONTRACTOR SHALL BE RESPONSIBLE FOR VERIFYING THE LOCATION AND DEPTH OF ALL UTILITIES PRIOR TO CONSTRUCTION. THE CONTRACTOR SHALL BE RESPONSIBLE FOR OBTAINING ALL NECESSARY PERMITS AND APPROVALS FROM THE CITY OF BENTON PRIOR TO CONSTRUCTION. THE CONTRACTOR SHALL BE RESPONSIBLE FOR OBTAINING ALL NECESSARY PERMITS AND APPROVALS FROM THE CITY OF BENTON PRIOR TO CONSTRUCTION.
 3. ALL UTILITIES, PIPES, POLES, GAS, PHONE, ETC. ARE SHOWN ON THE PLAN. THE CONTRACTOR SHALL BE RESPONSIBLE FOR VERIFYING THE LOCATION AND DEPTH OF ALL UTILITIES PRIOR TO CONSTRUCTION. THE CONTRACTOR SHALL BE RESPONSIBLE FOR OBTAINING ALL NECESSARY PERMITS AND APPROVALS FROM THE CITY OF BENTON PRIOR TO CONSTRUCTION.
 4. ALL UTILITIES, PIPES, POLES, GAS, PHONE, ETC. ARE SHOWN ON THE PLAN. THE CONTRACTOR SHALL BE RESPONSIBLE FOR VERIFYING THE LOCATION AND DEPTH OF ALL UTILITIES PRIOR TO CONSTRUCTION. THE CONTRACTOR SHALL BE RESPONSIBLE FOR OBTAINING ALL NECESSARY PERMITS AND APPROVALS FROM THE CITY OF BENTON PRIOR TO CONSTRUCTION.
 5. ALL UTILITIES, PIPES, POLES, GAS, PHONE, ETC. ARE SHOWN ON THE PLAN. THE CONTRACTOR SHALL BE RESPONSIBLE FOR VERIFYING THE LOCATION AND DEPTH OF ALL UTILITIES PRIOR TO CONSTRUCTION. THE CONTRACTOR SHALL BE RESPONSIBLE FOR OBTAINING ALL NECESSARY PERMITS AND APPROVALS FROM THE CITY OF BENTON PRIOR TO CONSTRUCTION.
 6. THE CONTRACTOR SHALL BE RESPONSIBLE FOR OBTAINING ALL NECESSARY PERMITS AND APPROVALS FROM THE CITY OF BENTON PRIOR TO CONSTRUCTION.
 7. UTILITIES SHALL BE PROTECTED AND NOT DAMAGED. THE CONTRACTOR SHALL BE RESPONSIBLE FOR OBTAINING ALL NECESSARY PERMITS AND APPROVALS FROM THE CITY OF BENTON PRIOR TO CONSTRUCTION.
 8. SPECIAL PROTECTIVE ENCLOSURES AT ALL LOCATIONS WHERE ANY UTILITIES CROSS EXISTING MATERIAL CAN LINES OR OTHER EXISTING UTILITIES SHALL BE PROVIDED BY THE CONTRACTOR.

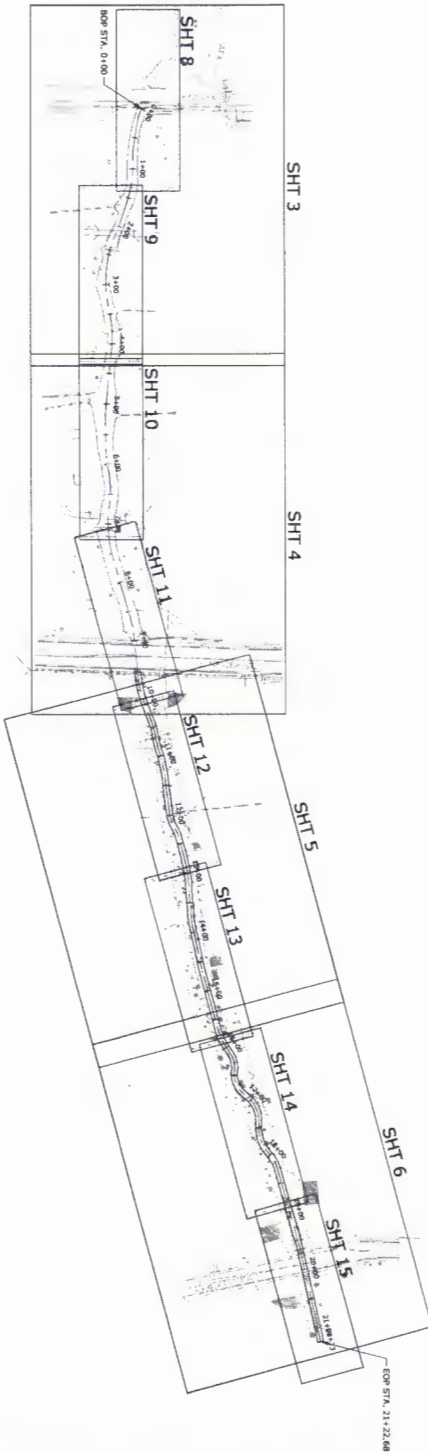

CEMYK-OD-FE KWH-MVK-2018-233
 MR. TONY FLOYD
 BENTON STREET DEPARTMENT

<p>PROJECT OVERVIEW</p> <p>DATE: JAN 2018</p> <p>BY: KAM</p> <p>CHECKED: KAM</p> <p>SCALE: 1" = 100'</p> <p>DATE PLOTTED: 1/15/2018</p>	<p>NO. DATE REVISION DESCRIPTION</p>	<p>811 One Call</p> <p>Now with 800-Call before you dig.</p>	<p>PRINCETON & MONTCLAIR DRAINAGE IMPROVEMENTS BENTON, ARKANSAS</p>	<p>MCE McCLELLAND CONSULTING ENGINEERS, INC.</p> <p>1570 N. Capital Blvd., Suite 200 Fayetteville, AR 72701 Phone: 479-493-1111 Fax: 479-493-1112</p> <p>7502 S. Green Rd., Box 401 Tulsa, OK 74136 Phone: 918-437-0272 Fax: 918-437-0273</p> <p>http://www.mce.us.com</p>
	<p>2</p>	<p>© 2017</p>	<p>17-5768-DEBC</p>	<p>17-5768-DEBC</p>

CEMVK-OD-FE KWH-MVK-2018-233
MR. TONY FLOYD
BENTON STREET DEPARTMENT

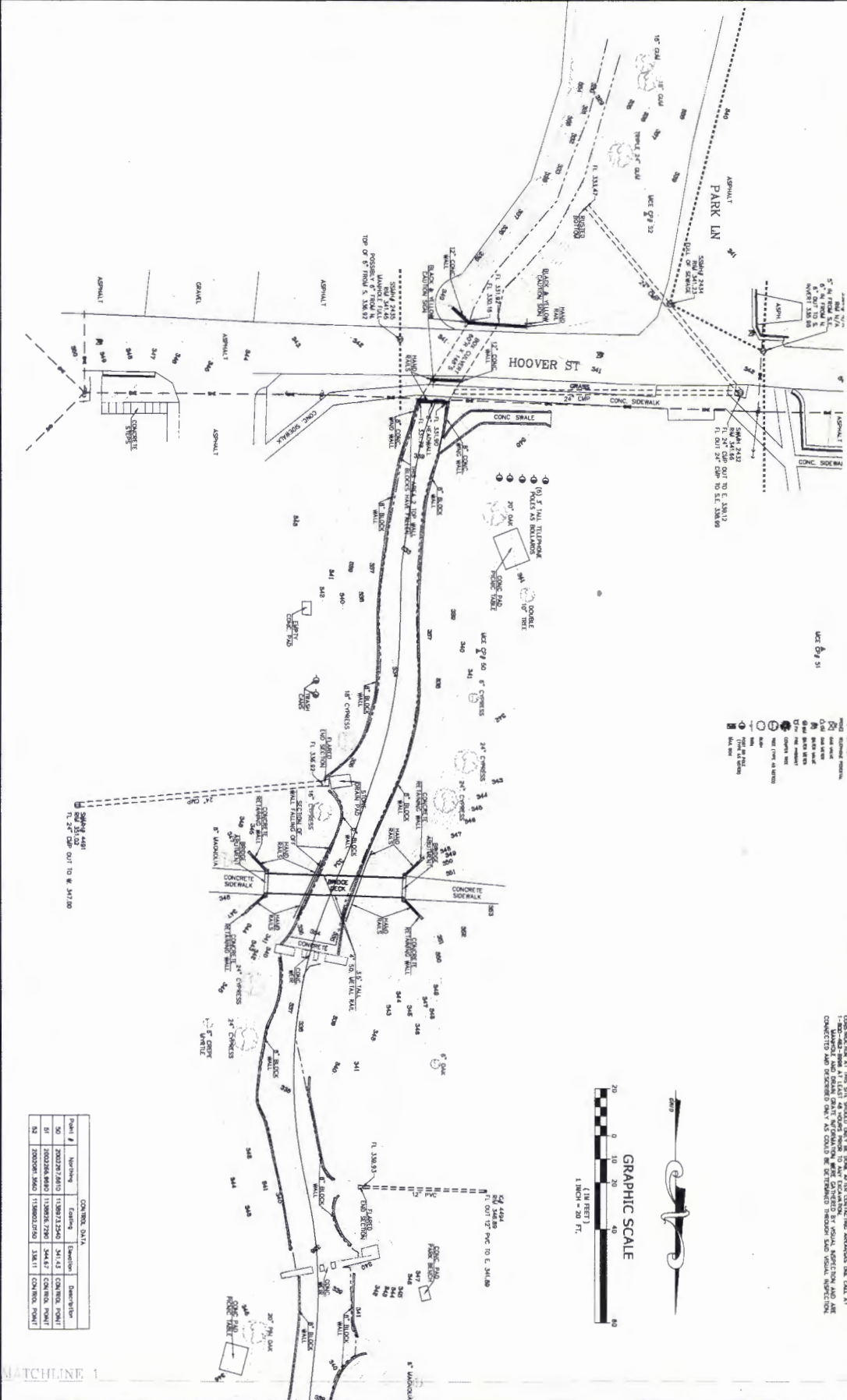

- LEGEND**
- 1. 1" = 100'
 - 2. 1" = 200'
 - 3. 1" = 300'
 - 4. 1" = 400'
 - 5. 1" = 500'
 - 6. 1" = 600'
 - 7. 1" = 700'
 - 8. 1" = 800'
 - 9. 1" = 900'
 - 10. 1" = 1000'
 - 11. 1" = 1100'
 - 12. 1" = 1200'
 - 13. 1" = 1300'
 - 14. 1" = 1400'
 - 15. 1" = 1500'
 - 16. 1" = 1600'
 - 17. 1" = 1700'
 - 18. 1" = 1800'
 - 19. 1" = 1900'
 - 20. 1" = 2000'
 - 21. 1" = 2100'
 - 22. 1" = 2200'
 - 23. 1" = 2300'
 - 24. 1" = 2400'
 - 25. 1" = 2500'
 - 26. 1" = 2600'
 - 27. 1" = 2700'
 - 28. 1" = 2800'
 - 29. 1" = 2900'
 - 30. 1" = 3000'
 - 31. 1" = 3100'
 - 32. 1" = 3200'
 - 33. 1" = 3300'
 - 34. 1" = 3400'
 - 35. 1" = 3500'
 - 36. 1" = 3600'
 - 37. 1" = 3700'
 - 38. 1" = 3800'
 - 39. 1" = 3900'
 - 40. 1" = 4000'
 - 41. 1" = 4100'
 - 42. 1" = 4200'
 - 43. 1" = 4300'
 - 44. 1" = 4400'
 - 45. 1" = 4500'
 - 46. 1" = 4600'
 - 47. 1" = 4700'
 - 48. 1" = 4800'
 - 49. 1" = 4900'
 - 50. 1" = 5000'
 - 51. 1" = 5100'
 - 52. 1" = 5200'
 - 53. 1" = 5300'
 - 54. 1" = 5400'
 - 55. 1" = 5500'
 - 56. 1" = 5600'
 - 57. 1" = 5700'
 - 58. 1" = 5800'
 - 59. 1" = 5900'
 - 60. 1" = 6000'
 - 61. 1" = 6100'
 - 62. 1" = 6200'
 - 63. 1" = 6300'
 - 64. 1" = 6400'
 - 65. 1" = 6500'
 - 66. 1" = 6600'
 - 67. 1" = 6700'
 - 68. 1" = 6800'
 - 69. 1" = 6900'
 - 70. 1" = 7000'
 - 71. 1" = 7100'
 - 72. 1" = 7200'
 - 73. 1" = 7300'
 - 74. 1" = 7400'
 - 75. 1" = 7500'
 - 76. 1" = 7600'
 - 77. 1" = 7700'
 - 78. 1" = 7800'
 - 79. 1" = 7900'
 - 80. 1" = 8000'
 - 81. 1" = 8100'
 - 82. 1" = 8200'
 - 83. 1" = 8300'
 - 84. 1" = 8400'
 - 85. 1" = 8500'
 - 86. 1" = 8600'
 - 87. 1" = 8700'
 - 88. 1" = 8800'
 - 89. 1" = 8900'
 - 90. 1" = 9000'
 - 91. 1" = 9100'
 - 92. 1" = 9200'
 - 93. 1" = 9300'
 - 94. 1" = 9400'
 - 95. 1" = 9500'
 - 96. 1" = 9600'
 - 97. 1" = 9700'
 - 98. 1" = 9800'
 - 99. 1" = 9900'
 - 100. 1" = 10000'



CONTROL DATA

Point #	Method	Existing	Location	Description
50	2002/28/2010	1158091.5246	341.43	CONCRETE POINT
51	2002/28/2010	1158091.7290	344.47	CONCRETE POINT
52	2002/08/2010	1158091.0760	338.11	CONCRETE POINT

SURVEYOR'S NOTES:
 THIS IS A TOPOGRAPHIC SURVEY ONLY AND NO WARRANTY SHOULD BE EXTENDED AS A PROPERTY BOUNDARY SURVEY. ANY PROPERTY LINES SHOWN ARE FOR REFERENCE ONLY AND HAVE NOT BEEN FIELD WORK FOR THIS SURVEY WAS COMPLETED DECEMBER, 2017.
 NO STATEMENT IS MADE CONCERNING SURVEYOR'S LIABILITY.
 BEING UTILIZED FOR DRAINAGE IMPROVEMENTS AND SLOPE DESIGN. THE SURVEYOR'S LIABILITY IS LIMITED TO THE TOPOGRAPHIC SURVEY ONLY AND NO WARRANTY SHOULD BE EXTENDED AS A PROPERTY BOUNDARY SURVEY. ANY PROPERTY LINES SHOWN ARE FOR REFERENCE ONLY AND HAVE NOT BEEN FIELD WORK FOR THIS SURVEY WAS COMPLETED DECEMBER, 2017.
 THE SURVEYOR'S LIABILITY IS LIMITED TO THE TOPOGRAPHIC SURVEY ONLY AND NO WARRANTY SHOULD BE EXTENDED AS A PROPERTY BOUNDARY SURVEY. ANY PROPERTY LINES SHOWN ARE FOR REFERENCE ONLY AND HAVE NOT BEEN FIELD WORK FOR THIS SURVEY WAS COMPLETED DECEMBER, 2017.

<p>TOPOGRAPHIC SURVEY</p> <p>3</p>	<p>Know what's below. Call before you dig.</p>	<p>PRINCETON & MONTCLAIR DRAINAGE IMPROVEMENTS BENTON, ARKANSAS</p>	<p>MCE McCLELLAND CONSULTING ENGINEERS, INC.</p> <p>1810 N. College Benton, AR 72015 Phone: 501-621-1222 Fax: 501-621-1223 http://www.mce.us.com</p>
---	--	---	---

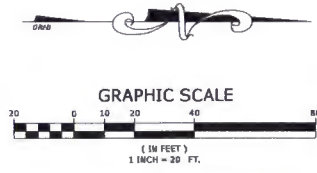

Point #	Northing	Eastng	Elevation	Description
10	2003249.8720	1138775.1370	369.09	CONTROL POINT
11	2003251.5070	1138953.8000	358.97	CONTROL POINT
12	2003248.7880	1139032.8340	367.53	CONTROL POINT
60	2003137.7530	1138967.6140	358.88	CONTROL POINT

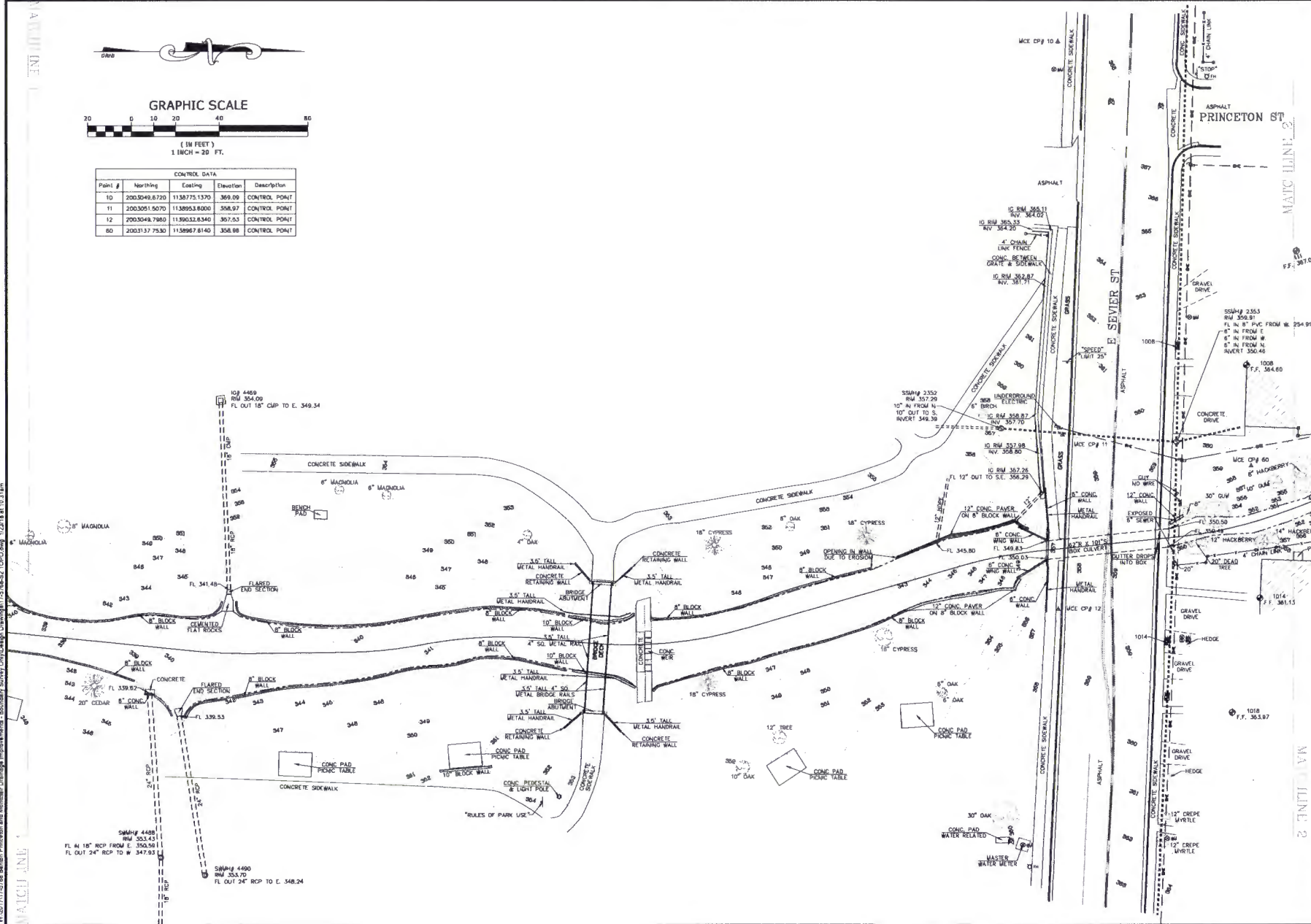

MCE
McCLELLAND
CONSULTING
ENGINEERS, INC.
 1705 South 22nd
 Little Rock, AR 72202
 PRR 507-75027
 FAX 507-75027
<http://www.mccell.com>

PRINCETON & MONTCLAIR
DRAINAGE IMPROVEMENTS
 BENTON, ARKANSAS

One Call
811
 Know what's below,
 Call before you dig.

TOPOGRAPHIC
SURVEY

DATE: 12/27/2017
 SCALE: 1" = 20'
 PLAN NUMBER: LB17-5706

CEMVK-OD-FE KWH-MVK-2018-233

MR. TONY FLOYD
BENTON STREET DEPARTMENT

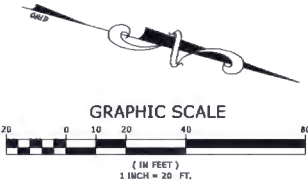
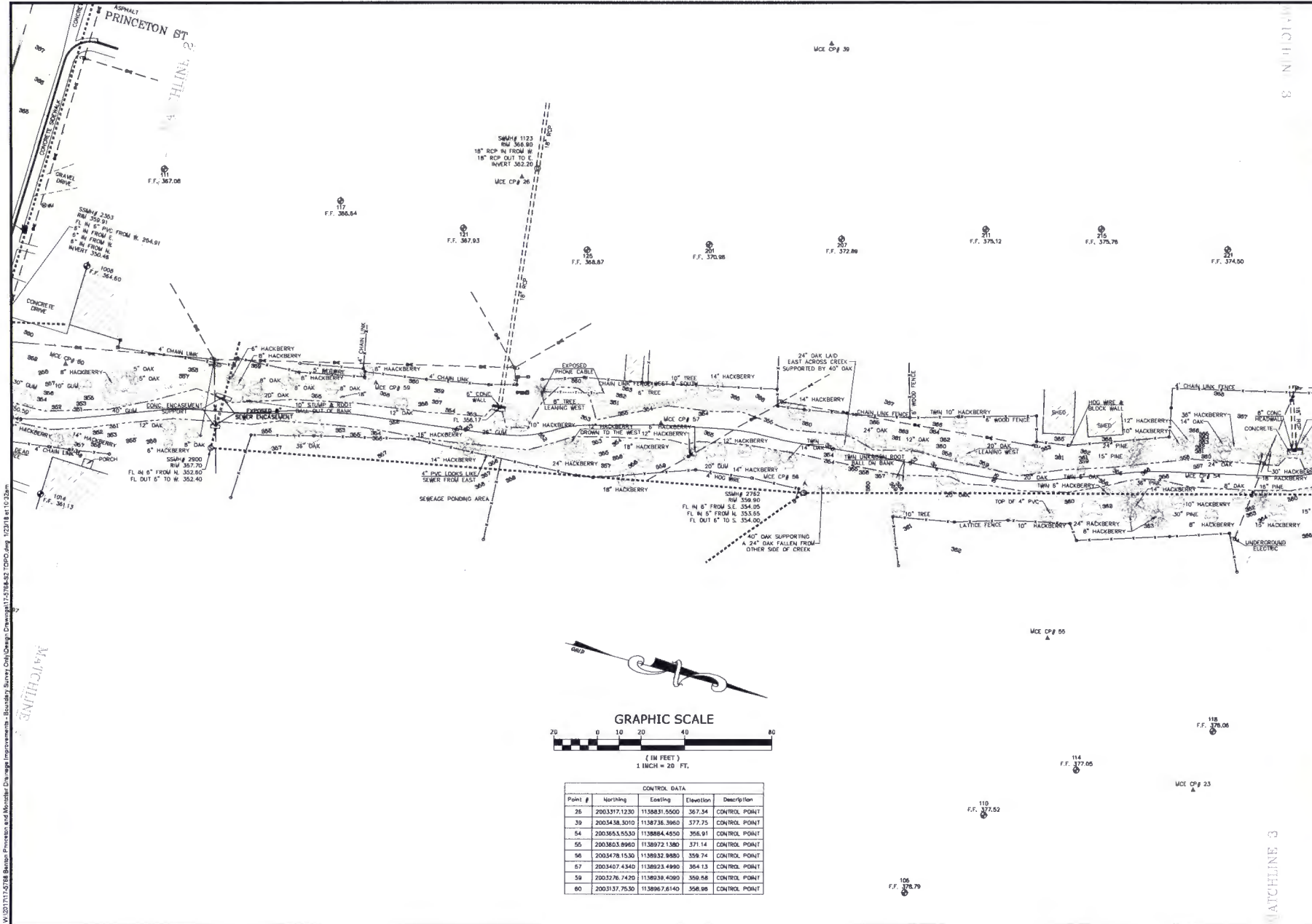

Point #	Northing	Easting	Elevation	Description
26	2003377.1230	1138831.5560	367.54	CONTROL POINT
39	2003438.3010	1138736.3960	377.75	CONTROL POINT
54	2003653.5530	1138884.4550	356.91	CONTROL POINT
50	2003653.8960	1138972.1380	371.14	CONTROL POINT
56	2003478.1530	1138932.9880	359.74	CONTROL POINT
57	2003407.4340	1138923.4990	354.13	CONTROL POINT
59	2003276.7420	1138939.4090	350.58	CONTROL POINT
60	2003137.7530	1138997.6140	356.98	CONTROL POINT

MCE McCLELLAND CONSULTING ENGINEERS, INC.
 1015 N. COLLETT
 302 S. LAMAR BLVD. 401
 BENTON, AR 72015
 PHONE: 501-771-0227
 FAX: 501-771-0228
<http://www.mce.us.com>

PRINCETON & MONICLAIR
 DRAINAGE IMPROVEMENTS
 BENTON, ARKANSAS

One Call
811
 Know what's below.
 Call before you dig.

NO.	DATE	DESCRIPTION

TOPOGRAPHIC SURVEY

DATE: 12/27/2017
 SCALE: 1" = 20'
 FOR NUMBER 1 & R: 17-5768

CEMVK-OD-FE KWH-MVK-2018-233

MR. TONY FLOYD
BENTON STREET DEPARTMENT

W:\2017\12-27-18 Benton Princeton and Montclair Drainage Improvements - Boundary Survey Only\Drawings\17-5768-SS-TOPD.dwg 12/27/18 10:32am

MATCHLINE 3

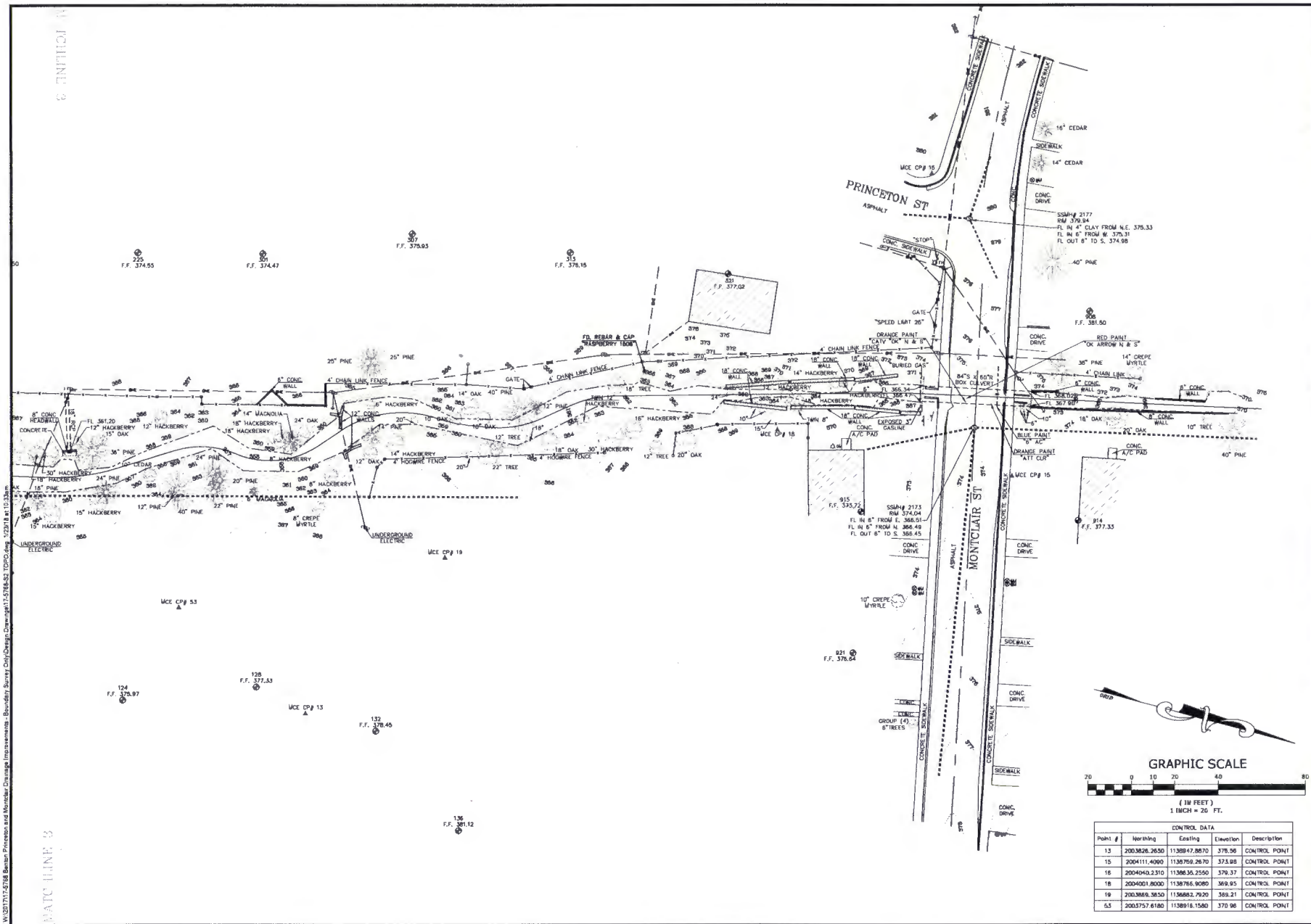

Point #	Northing	Easting	Elevation	Description
13	200.826.2650	11389.47.8670	375.56	CONTROL POINT
15	200.411.4090	11387.66.2670	373.88	CONTROL POINT
16	200.404.2310	11386.36.2550	370.37	CONTROL POINT
18	200.400.8000	11387.66.9080	369.45	CONTROL POINT
19	200.866.3650	11566.82.7920	368.21	CONTROL POINT
23	200.375.6180	11389.16.1580	370.98	CONTROL POINT

MCE
McCLELLAND CONSULTING ENGINEERS, INC.
 1100 S. GUYTON ST.
 BENTON, ARKANSAS 72712
 PHONE: (501) 376-1234
 FAX: (501) 376-1235
 WWW: WWW.MCE.US

PRINCETON & MONTCLAIR DRAINAGE IMPROVEMENTS
 BENTON, ARKANSAS

One Call 811
 Know what's below. Call before you dig.

TOPOGRAPHIC SURVEY

PROPERTY OWNER: KJH, INC.
 SURVEY NUMBER: JDM
 DATE: 12/27/2017
 SCALE: 1" = 20'
 PLOT NUMBER: 1.2 (17-376A)

CEMVK-OD-FE KWH-MVK-2018-233

**MR. TONY FLOYD
 BENTON STREET DEPARTMENT**

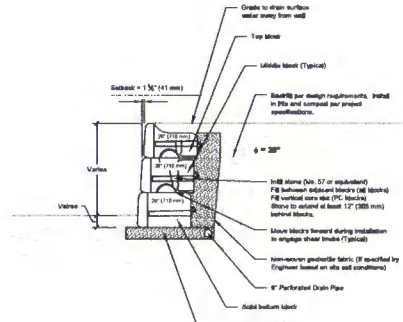

4'-6" GRAVITY WALL
N.T.S.

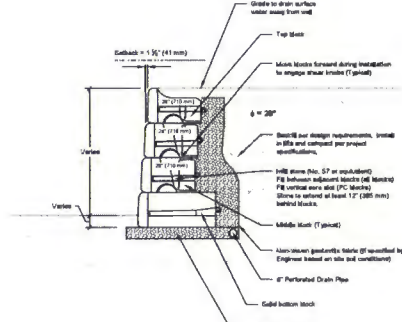

6'-0" GRAVITY WALL
N.T.S.

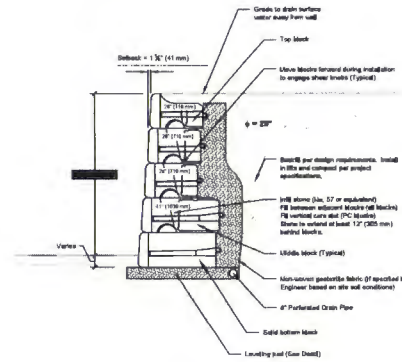

7'-6" GRAVITY WALL
N.T.S.

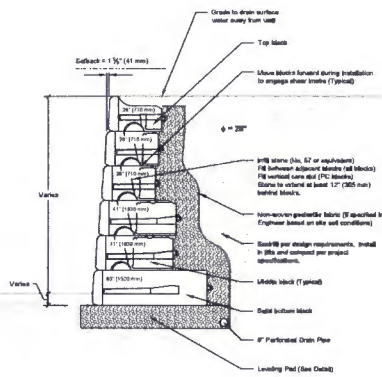

9'-0" GRAVITY WALL
N.T.S.

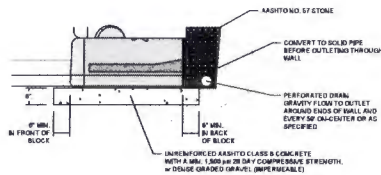

CONCRETE LEVELING PAD
N.T.S.

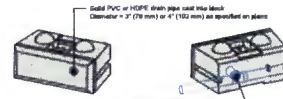

DRAINAGE WEEP OPTION 1
N.T.S.

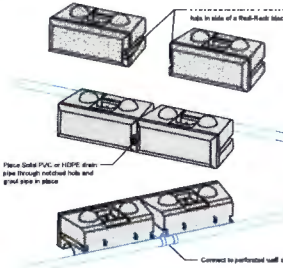

DRAINAGE WEEP OPTION 2
N.T.S.

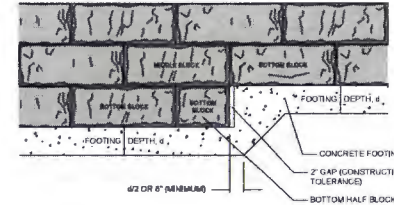

STEP FOOTING DETAIL
N.T.S.

W:\2017\17-2768-Block Drain-Princeton and Montclair-Drainage Improvements - Block Drain Survey Only\Design\Drawings\17-2768-Block Drain.dwg 2/6/18 11:41:58am

MCE
McCLELLAND
CONSULTING
ENGINEERS, INC.
1322 E. 17th Street
Benton, Arkansas 72815
Phone: 501-757-0277
Fax: 501-757-0277
http://www.mceinc.com

UNUSUAL SENSATION FIELD

PRINCETON & MONTCLAIR
DRAINAGE IMPROVEMENTS
BENTON, ARKANSAS

One Call
811
Know what's below.
Call before you dig.

NO.	DATE	REVISION DESCRIPTION

TYPICAL SECTIONS OF IMPROVEMENT

PROJECT TEAM	DESIGNED BY
RNB	JAM
DATE	FEBRUARY 2018
SCALE	N.T.S.
DWG NUMBER	17-2768-10

CEMVK-OD-FE KWH-MVK-2018-233

MR. TONY FLOYD
BENTON STREET DEPARTMENT

W:\2017\17-01388 Benton Privatisation and Municipal Drainage Improvements - Boundary Survey Only\Change Drawings\17-01388-DESIGN.dwg 3/6/18 at 8:49am

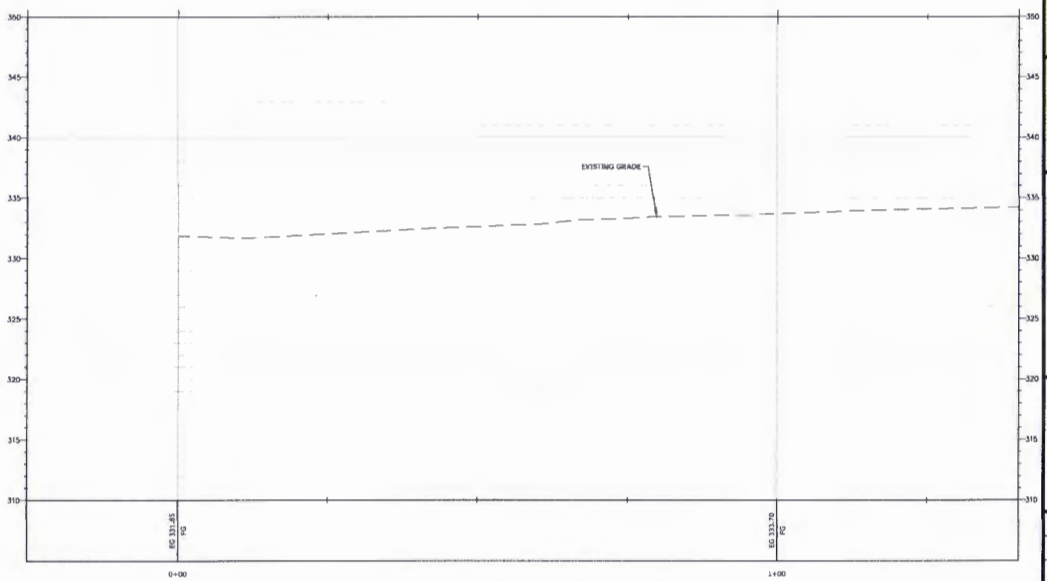
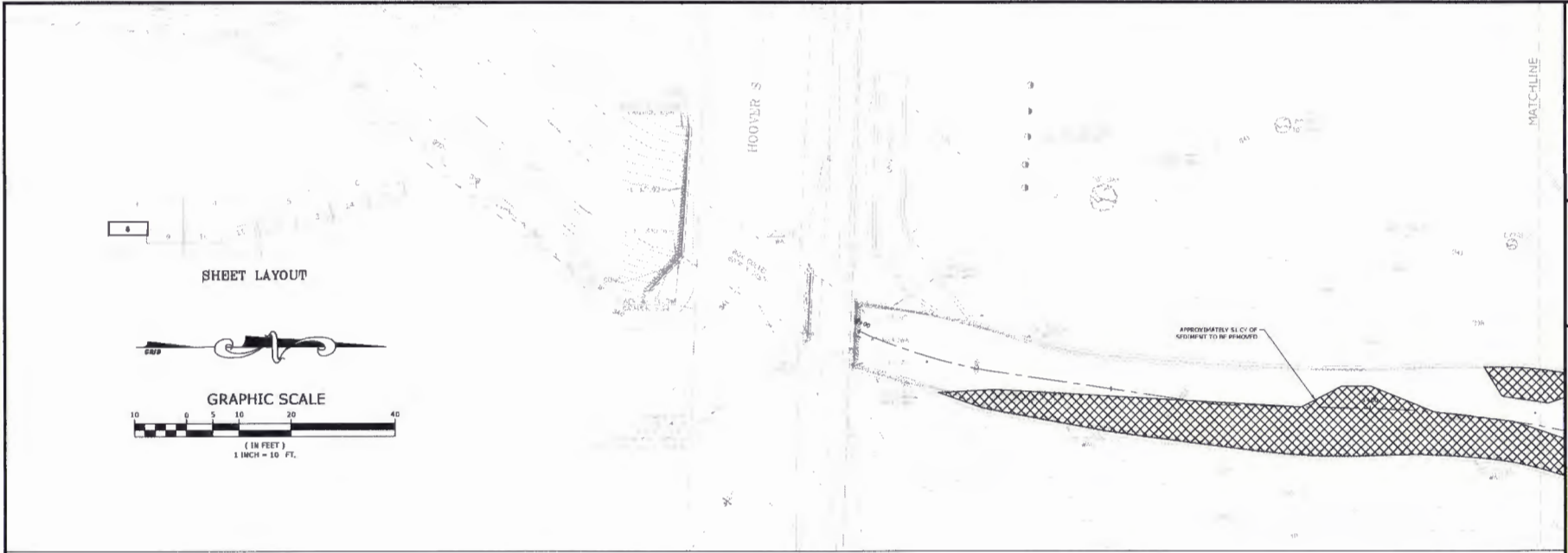

DITCH CENTERLINE PROFILE SCALE: 1"=10' HORIZ. 1"=5' VERT.

MCE
McCLELLAND CONSULTING ENGINEERS, INC.
 1825 S. College Ave.
 Benton, Arkansas 72015
 501-753-7527
 http://www.mce.usa.com

ORIGINAL SUBMITTED TO FILE

PRINCETON & MONTCLAIR DRAINAGE IMPROVEMENTS
 BENTON, ARKANSAS

One Call 811
 Know what's below. Call before you dig.

REV.	DATE	DESCRIPTION

DESIGNED BY	DATE
CHECKED BY	DATE
APPROVED BY	DATE
PROJECT NUMBER	DATE

CEMVK-OD-FE KWH-MVK-2018-233

**MR. TONY FLOYD
 BENTON STREET DEPARTMENT**

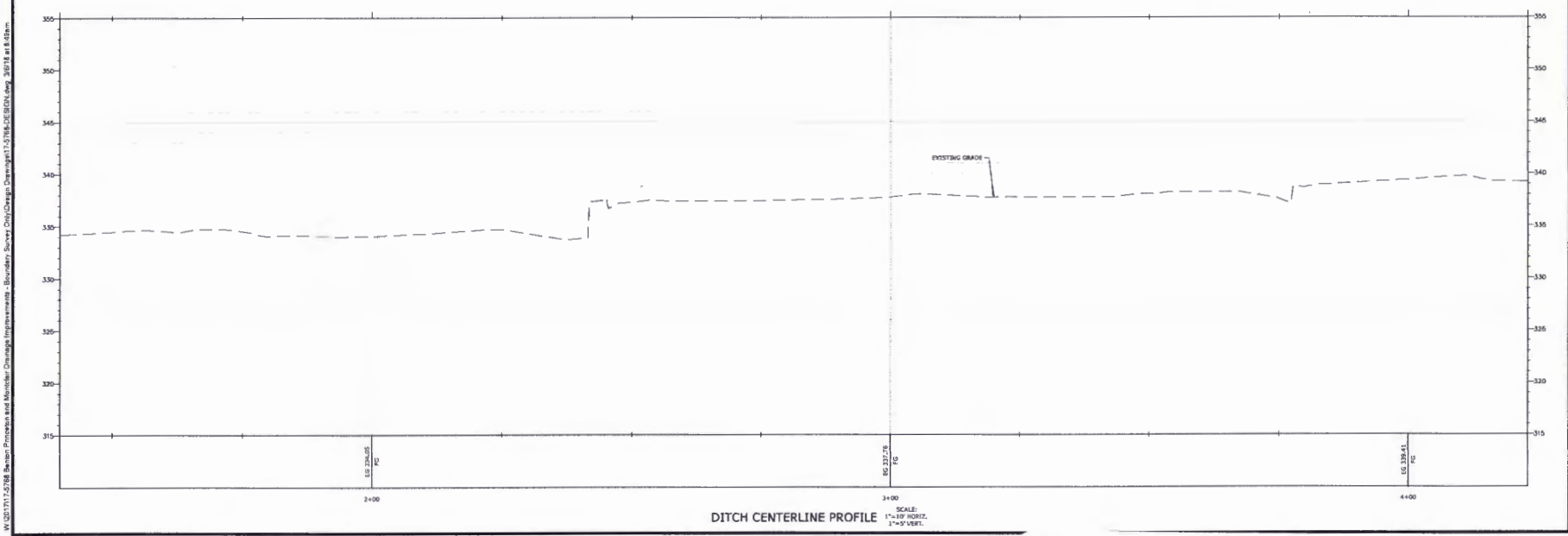
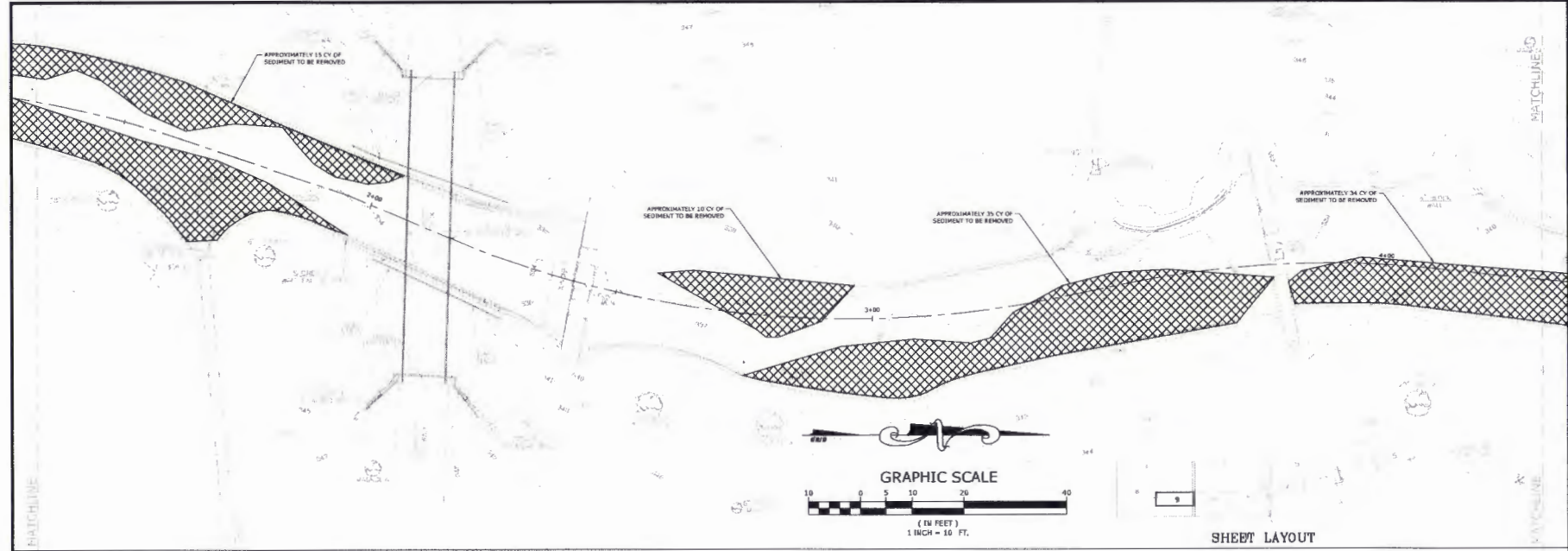

W:\021711-2-21-2018 Benton Streets and Monitor Drainage Improvements - Boundary Survey City\Drawn_Drainage\1-2-2018-DECDL.dwg 2/17/18 at 8:09am

MCE
McCLELLAND
CONSULTING
ENGINEERS, INC.
 1325 South 7th
 Fort Worth, Texas 76104
 Phone: 817-342-2222
 Fax: 817-342-2227
<http://www.mce.usa.com>

EXISTENTIAL BOUNDARY ON FILE

PRINCETON & MONTCLAIR
DRAINAGE IMPROVEMENTS
 BENTON, ARKANSAS

One Call
811
 Know what's below.
 Call before you dig.

NO.	DATE	DESCRIPTION

DITCH PLAN & PROFILE	
PROJECT FAVOR	DESIGNED BY
RD	JAM
DATE	JAN 2018
SCALE	FOR MEASUREMENT
1" = 10'	LR 17-5708

CEMVK-OD-FE KWH-MVK-2018-233

MR. TONY FLOYD
BENTON STREET DEPARTMENT

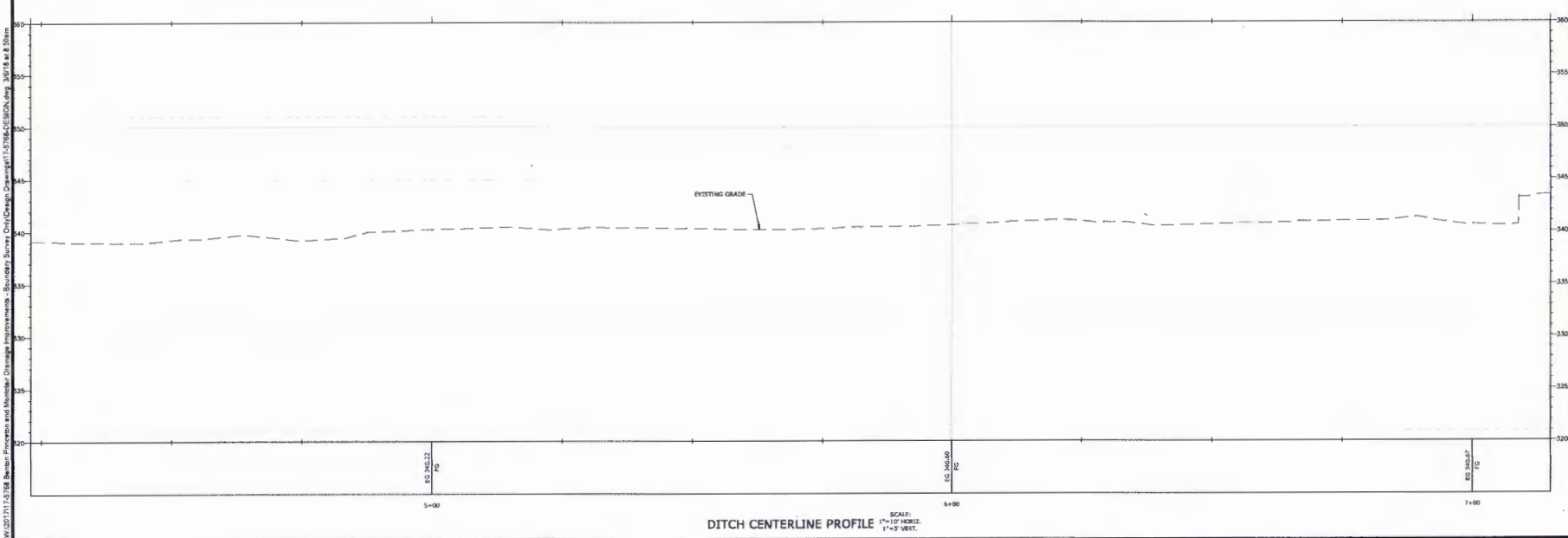
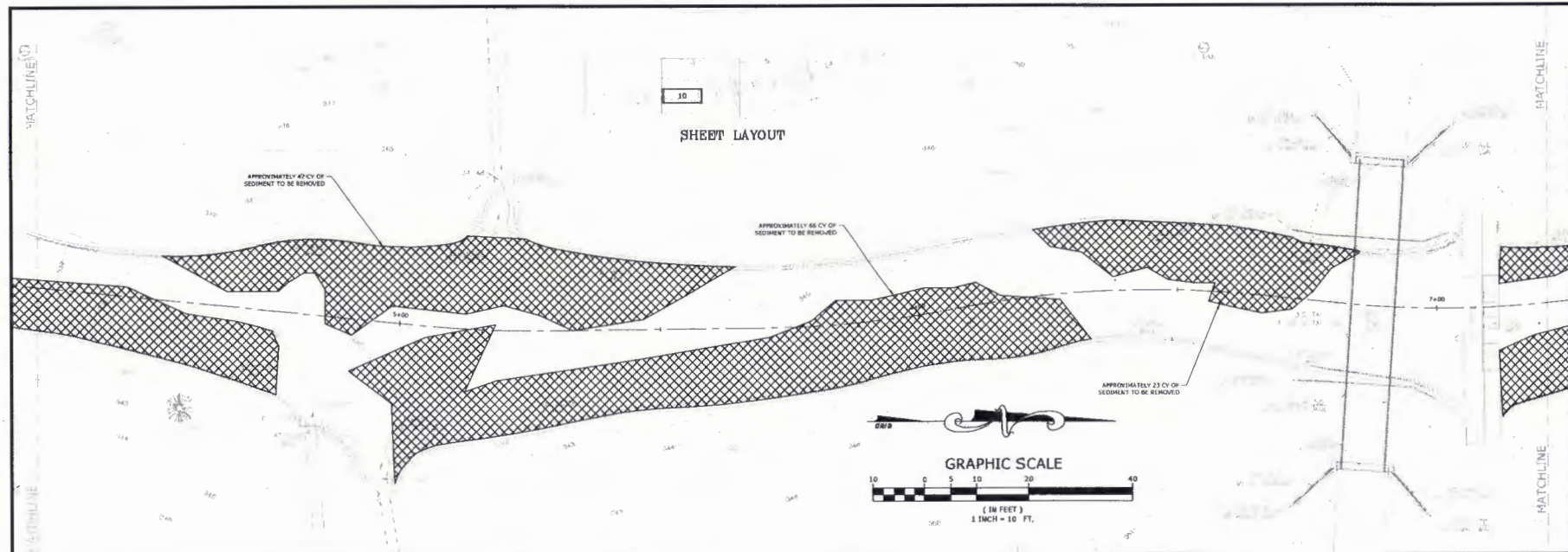

W:\2017\11-15-18_Benton-Preceptors and Monitor Drainage Improvements - Boundary Survey Civil\Design_Drawings\17-0796-DESIGN.dwg 3/8/18 11:48:29am

MCE
McCLELLAND
CONSULTING
ENGINEERS, INC.
 1322 South St.
 Benton, Arkansas 72015
 501-757-0272
 501-757-0273
 http://www.mce.us.com

PRINCETON & MONTCLAIR
 DRAINAGE IMPROVEMENTS
 BENTON, ARKANSAS

One Call
811
 Know what's below.
 Call before you dig.

NO.	DATE	REVISION / DESCRIPTION

DITCH PLAN & PROFILE	
PROJECT NUMBER	JAM
DATE	JAN 2018
SCALE	1" = 10'
DRAWING NUMBER	LR:17-5768
10	

CEMVK-OD-FE KWH-MVK-2018-233

MR. TONY FLOYD
BENTON STREET DEPARTMENT

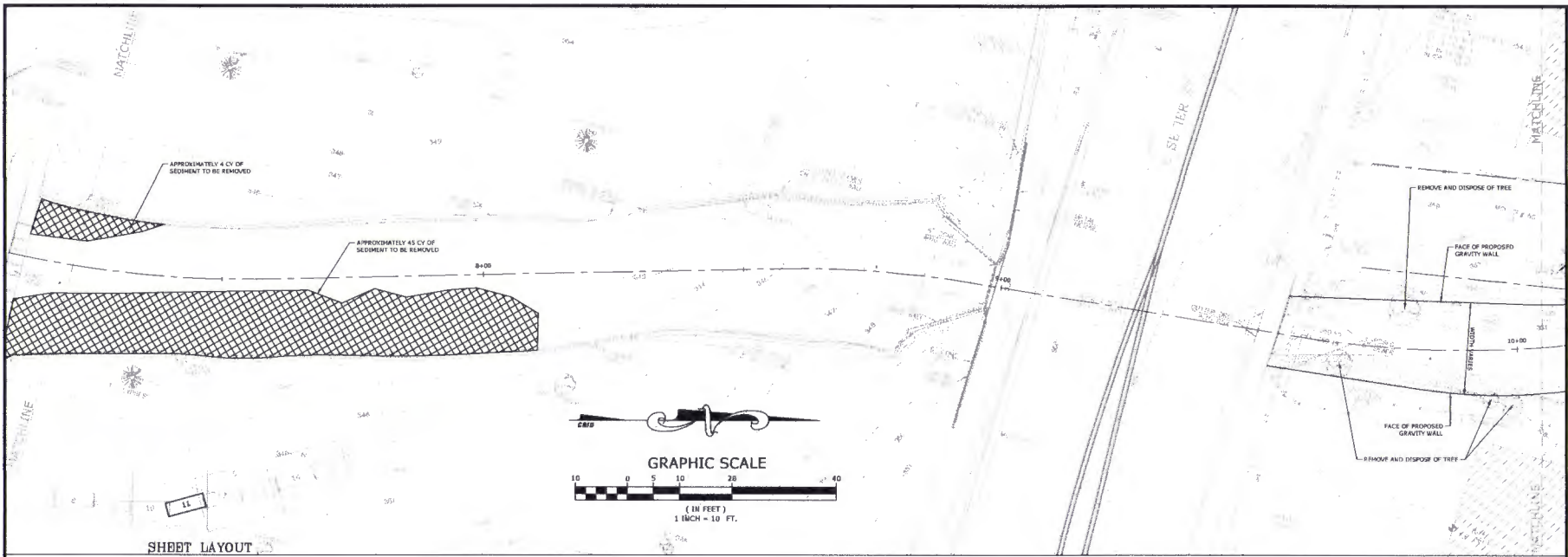

SHBET LAYOUT

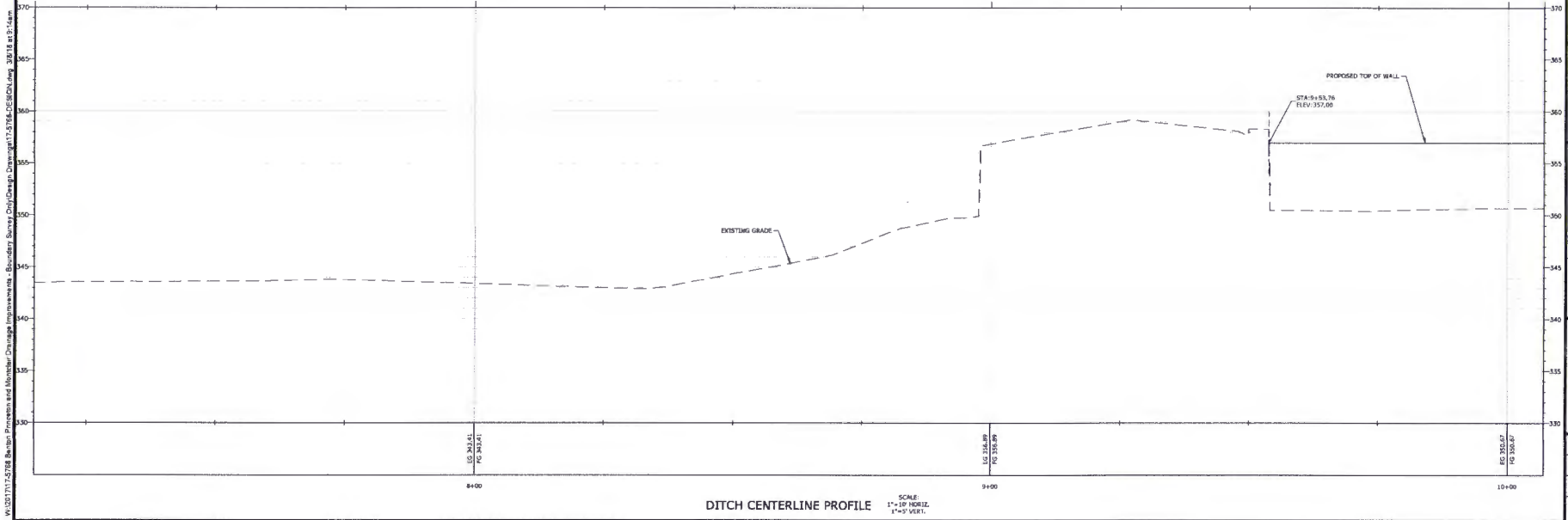

DITCH CENTERLINE PROFILE

SCALE:
1"=10' HORIZ.
1"=5' VERT.

MCE
McCLELLAND
CONSULTING
ENGINEERS, INC.
1700 S. GUYTON
LITTLE ROCK, AR 72202
PH: 501-717-0277
FAX: 501-717-0277
http://www.mce.in.com

ORIGINAL SUBMITTALS ON FILE
C 2017

PRINCETON & MONTCLAIR
DRAINAGE IMPROVEMENTS
BENTON, ARKANSAS

One Call
811
Know what's below.
Call before you dig.

NO.	DATE	REVISION DESCRIPTION

DITCH PLAN & PROFILE

PROJECT NUMBER: 1817-5708
DRAWN BY: JAM
DATE: JAN 2018
SCALE: 1"=10'
JOB NUMBER: 1817-5708

CEMVK-OD-FE KWH-MVK-2018-233

MR. TONY FLOYD
BENTON STREET DEPARTMENT

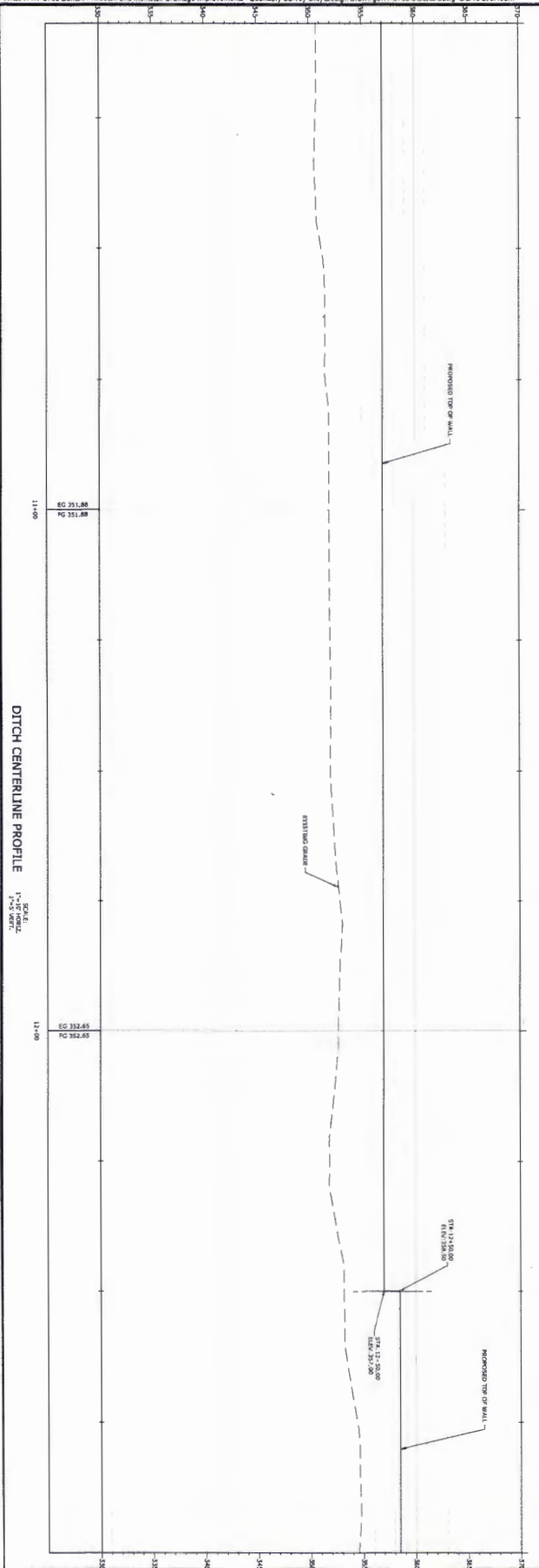
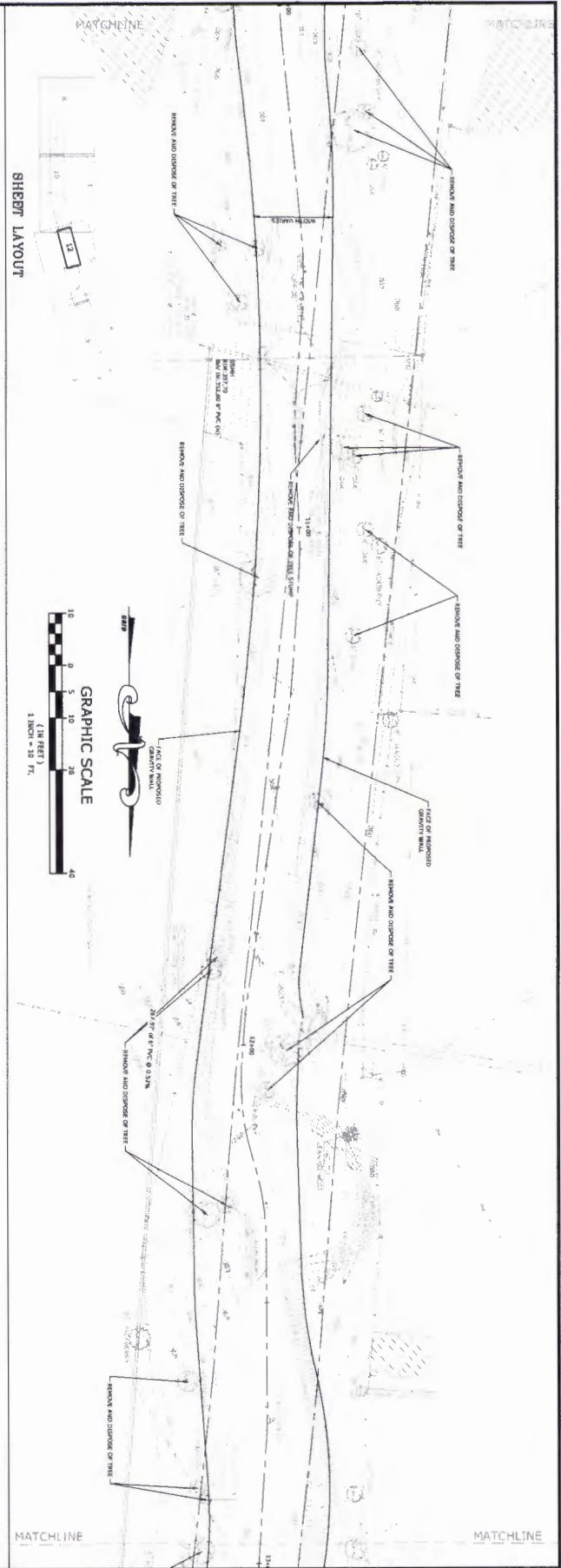

<p>811 One Call Call before you dig. www.callbeforeyoudig.com</p>	<p>PRINCETON & MONTCLAIR DRAINAGE IMPROVEMENTS BENTON, ARKANSAS</p>	<p>MCE McCLELLAND CONSULTING ENGINEERS, INC. 1801 N. College Fayetteville, AR 72703 Phone: 479-482-2377 Fax: 479-482-2377</p>	<p>7801 East 84th Little Rock, AR 72204 Phone: 501-771-0272 Fax: 501-771-0272</p> <p>4005 S. Colman Rd. No. 402 Tulsa, OK 74146 Phone: 918-410-8882</p> <p>http://www.mce-us.com</p>						
<p>DITCH PLAN & PROFILE</p>	<table border="1" style="width: 100%; border-collapse: collapse;"> <thead> <tr> <th style="width: 5%;">NO.</th> <th style="width: 10%;">DATE</th> <th style="width: 85%;">DESCRIPTION</th> </tr> </thead> <tbody> <tr> <td> </td> <td> </td> <td> </td> </tr> </tbody> </table>	NO.	DATE	DESCRIPTION				<p>DATE OF ISSUE: 03/08/2018 BY: JAF CHECKED BY: JAF</p>	<p>PROJECT NO: 17-5768 SHEET NO: 12</p>
NO.	DATE	DESCRIPTION							

MR. TONY FLOYD
BENTON STREET DEPARTMENT
CEMYK-OD-FE KWH-MVK-2018-233

DITCH CENTERLINE PROFILE

SCALE
1" = 2' VERT.
1" = 20' HORIZ.

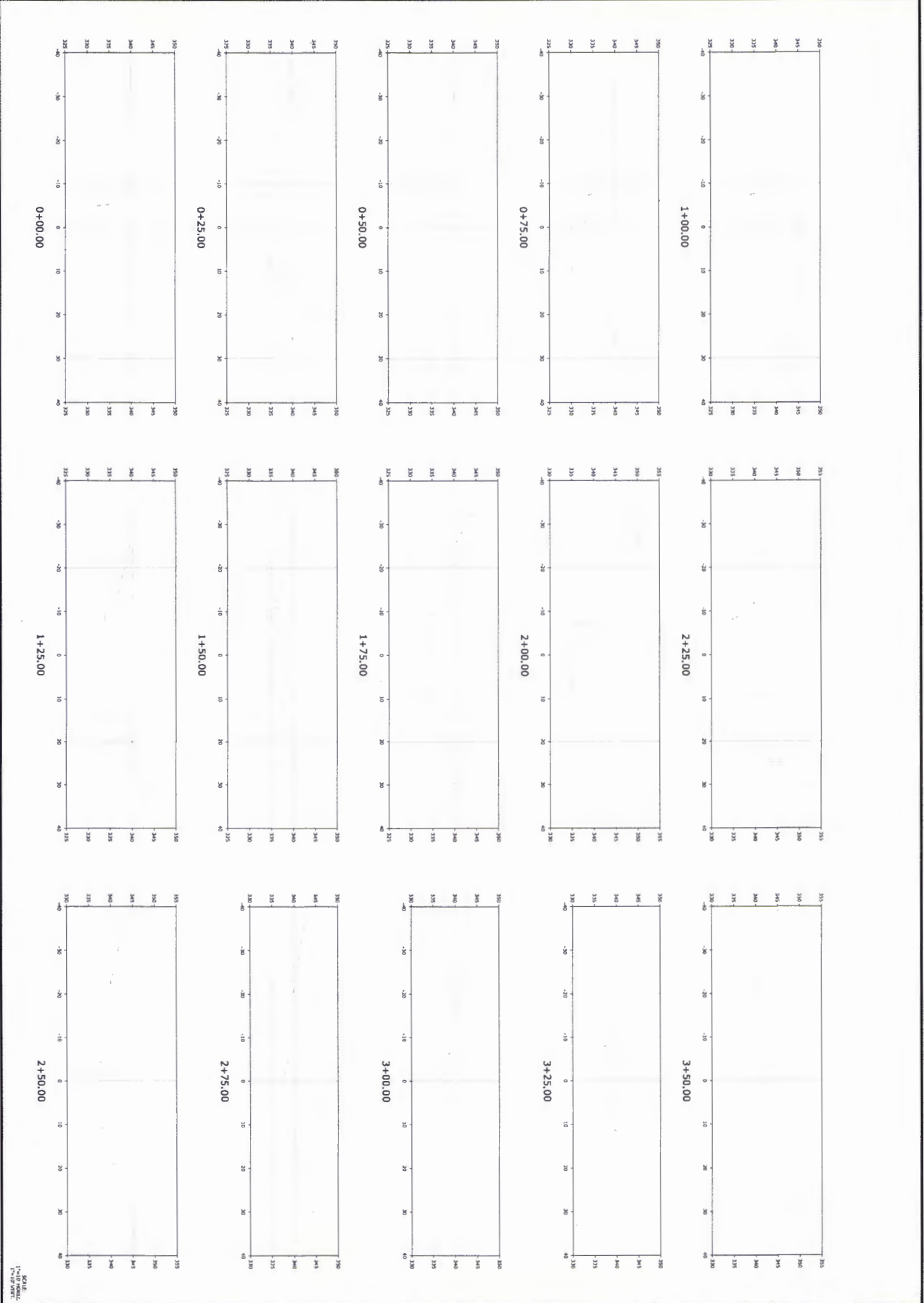

DATE: 1/10/18
 TIME: 10:47 AM

NO.	DATE	DESCRIPTION

CROSS SECTIONS FROM STA. 0+00.00 TO STA. 3+50.00



PRINCETON & MONTCLAIR DRAINAGE IMPROVEMENTS
 BENTON, ARKANSAS

MCE McCLELLAND CONSULTING ENGINEERS, INC.

1051 N. College Fayetteville, AR 72703
 479-445-2377

1300 S. College Fayetteville, AR 72703
 479-445-2377

600 S. College Fayetteville, AR 72703
 479-445-2377

http://www.mce.us.com

CEMVK-OD-FE KWH-MVK-2018-233
 MR. TONY FLOYD
 BENTON STREET DEPARTMENT

M:\2017\151768 Benton Street and Montclair Drainage Improvements - Boundary Survey Civil Design Drawings\151768\CEMVK-OD-FE.dwg 3/8/18 at 1:55pm

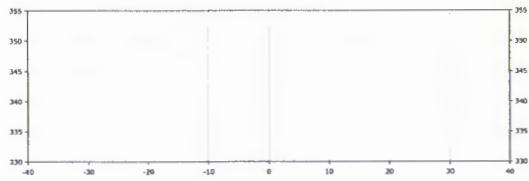

4+75.00

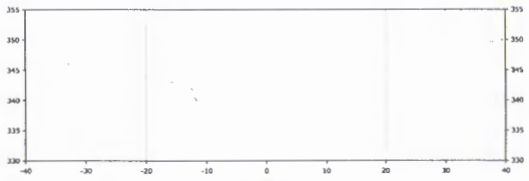

6+00.00

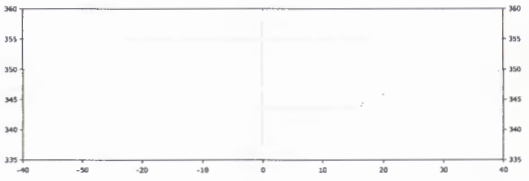

7+25.00

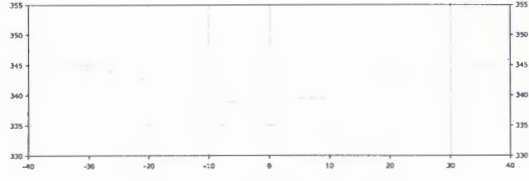

4+50.00

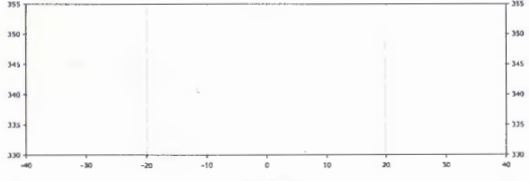

5+75.00

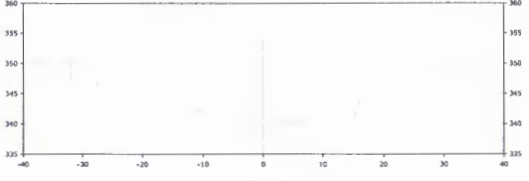

7+00.00

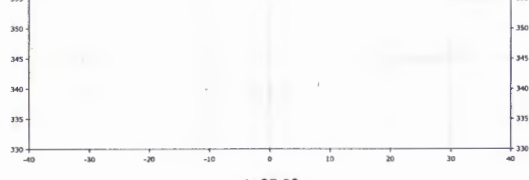

4+25.00

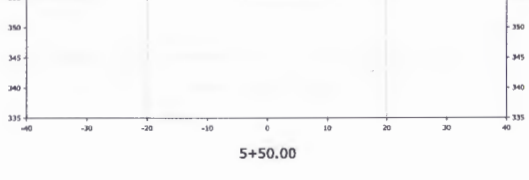

5+50.00

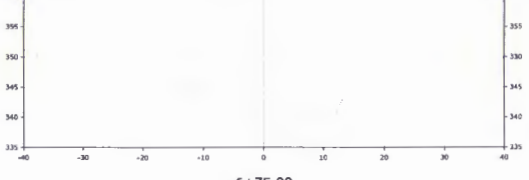

6+75.00

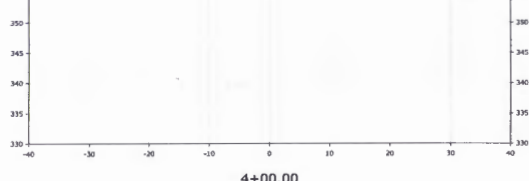

4+00.00

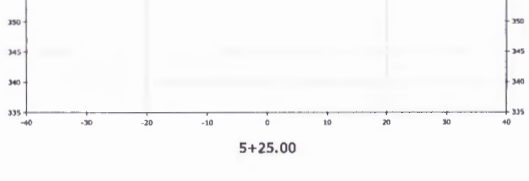

5+25.00

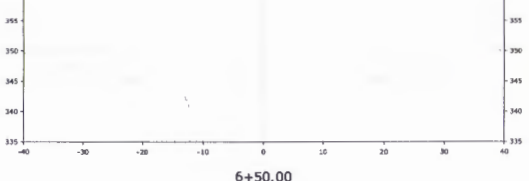

6+50.00

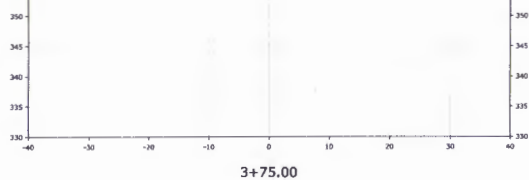

3+75.00

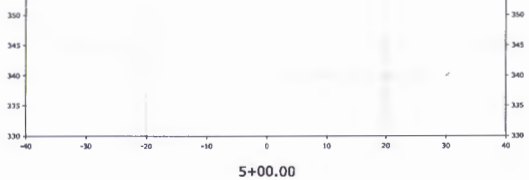

5+00.00

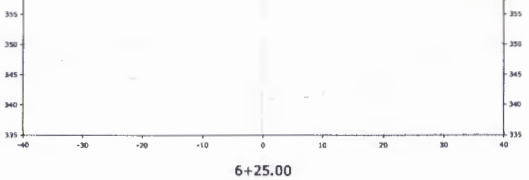

6+25.00

MCE
McCLELLAND CONSULTING ENGINEERS, INC.
 1105 S. CLAYTON
 SUITE 100
 BENTON, ARKANSAS 72715
 (501) 271-2222
 (501) 271-2223
 (501) 271-2224
 http://www.mce-inc.com

ORIGINAL, NO MATTERS, OR FILE

**PRINCETON & MONTCLAIR
 DRAINAGE IMPROVEMENTS**
 BENTON, ARKANSAS

One Call
811
 Know what's below.
 Call before you dig.

NO.	DATE	REVISIONS	DESCRIPTION

**CROSS SECTIONS
 STA. 3+75.00
 TO STA. 7+25.00**

PROJECT NO.	DATE
151768	JAN 2018
DESIGNED BY	DATE
JAM	JAM
CHECKED BY	DATE
JAM	JAM
SCALE	FOR NUMBER
AS SHOWN	151768-001

SCALE:
 1"=10' HORIZ.
 1"=10' VERT.

CEMVK-OD-FE KWH-MVK-2018-233

**MR. TONY FLOYD
 BENTON STREET DEPARTMENT**

W:\2017\17-2106-Benton-Prevention-and-Minor-Drainage-Improvements-Boundary-Survey-Drawings\17-2106-CEMVK.dwg 3/16/18 at 8:56am

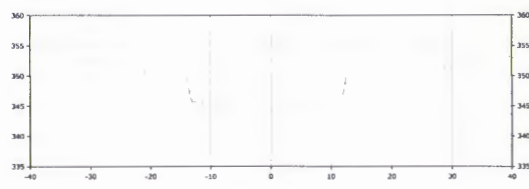

8+50.00

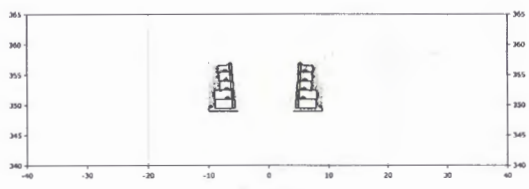

9+56.53

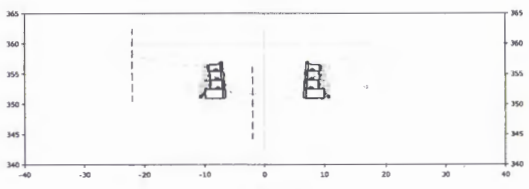

10+69.82

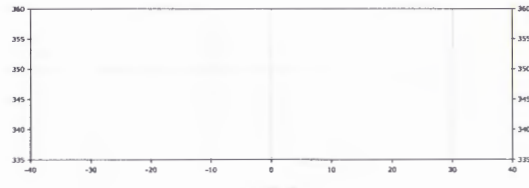

8+25.00

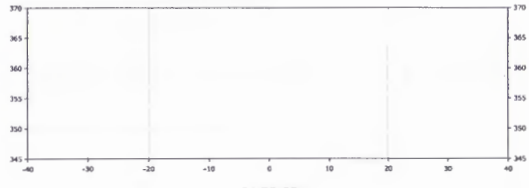

9+50.00

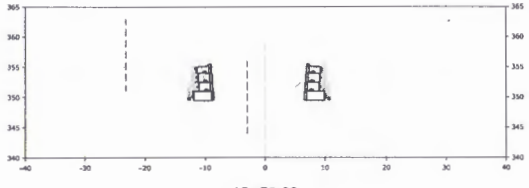

10+50.00

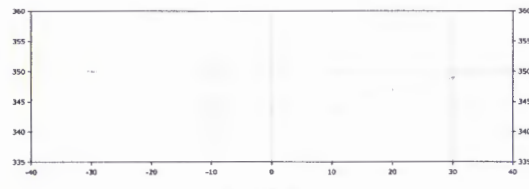

8+00.00

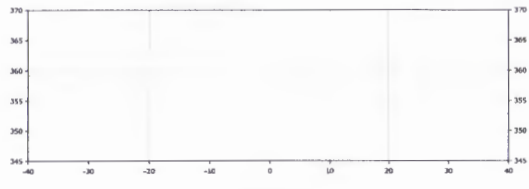

9+25.00

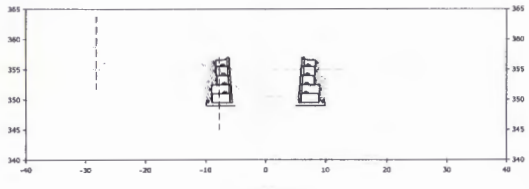

10+25.00

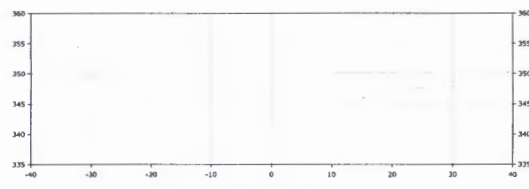

7+75.00

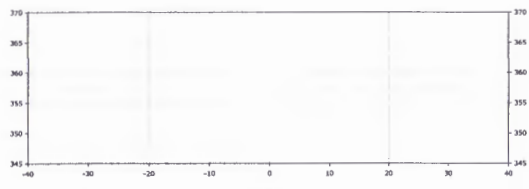

9+00.00

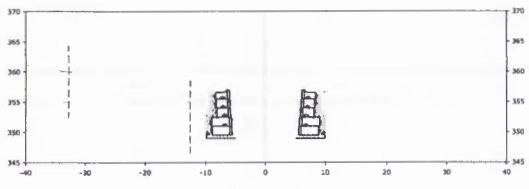

10+00.00

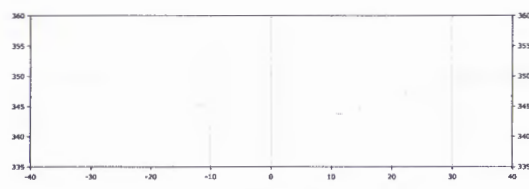

7+50.00

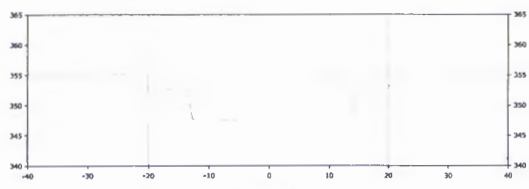

8+75.00

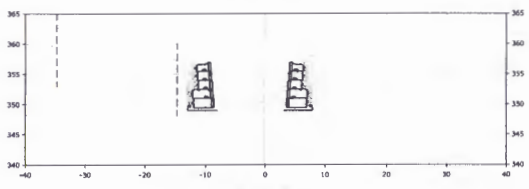

9+75.00

MCE
McCLELLAND
CONSULTING
ENGINEERS, INC.
 1725 East 27th
 Benton, Arkansas 72015
 501-271-7077
 501-271-8489
<http://www.mccc.us.com>

VERTICAL ALIGNMENT FILE

PRINCETON & MONTCLAIR
DRAINAGE IMPROVEMENTS
 BENTON, ARKANSAS

One Call
811
 Know what's below.
 Call before you dig.

NO.	DATE	REVISION	DESCRIPTION

CROSS
 SECTIONS
 STA. 7+50.00
 TO STA. 10+69.82

PROJECT NO.	17-2106
DATE	JAN 2018
SCALE	AS SHOWN
FOR NUMBER	LRI 17-2106

SCALE
 1"=10' HORIZ.
 1"=10' VERT.

CEMVK-OD-FE KWH-MVK-2018-233

MR. TONY FLOYD
BENTON STREET DEPARTMENT

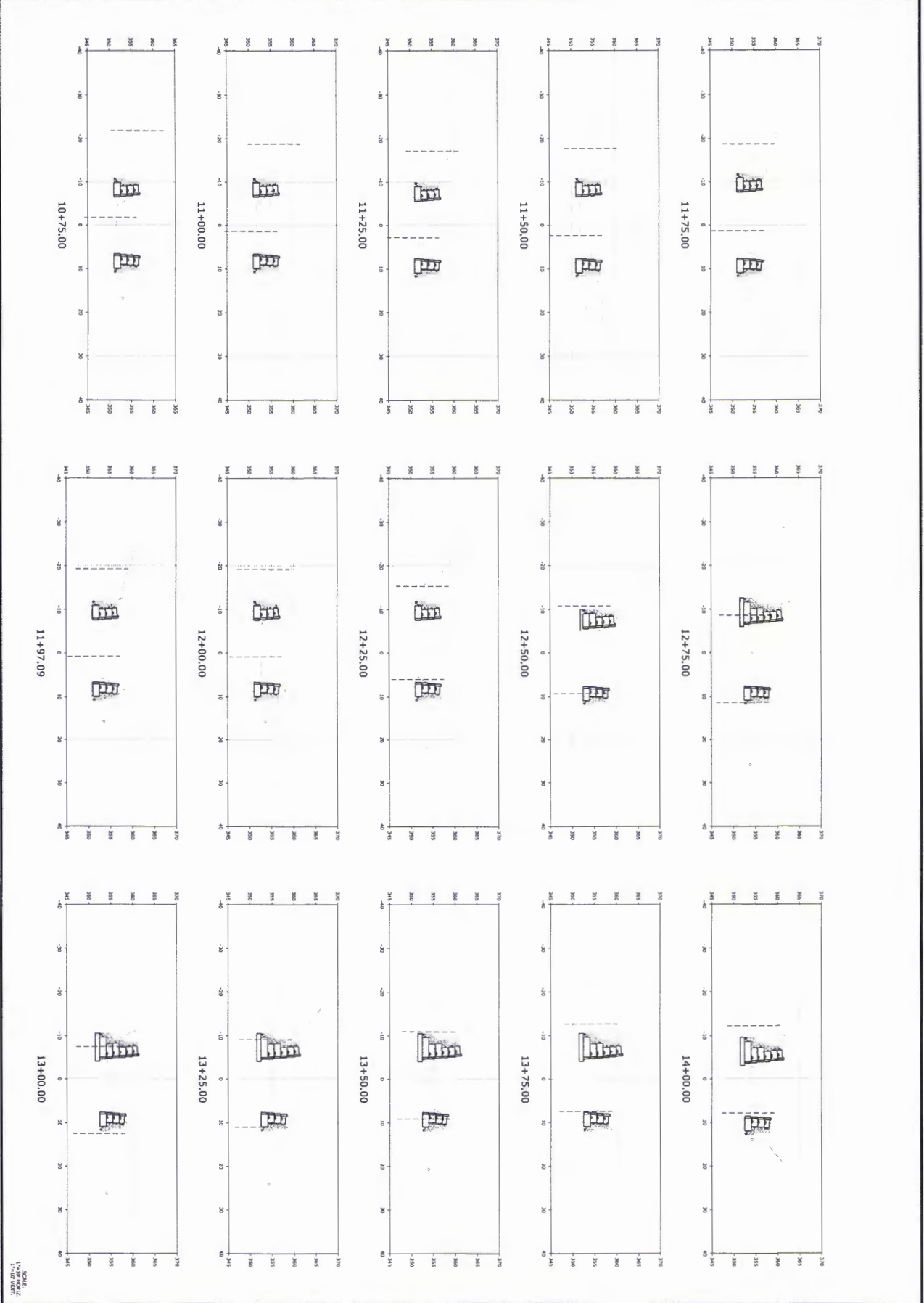

DATE: 1-17-18
 19 OF 19 SHEETS

NO.	DATE	REVISION DESCRIPTION

CROSS SECTIONING STA. 10+75.00 TO STA. 14+00.00
 DATE: JAN 2018
 DRAWN BY: ASHBY/ML
 CHECKED BY: JAAH
 19

811
 Request a Quote
 Call before you dig

PRINCETON & MONTCLAIR
 DRAINAGE IMPROVEMENTS
 BENTON, ARKANSAS

MCE McCLELLAND CONSULTING ENGINEERS, INC.
 1702 S. GARDNER, BENTON, AR 72015
 408 S. GARDNER BLVD. #101, BENTON, AR 72015
 501 S. GARDNER BLVD. #101, BENTON, AR 72015
 767-622-2217
 767-622-2217
 767-622-2217
<http://www.mce.us.com>

MR. TONY FLOYD
 BENTON STREET DEPARTMENT
 CEMVK-OD-FE KWH-MVK-2018-233

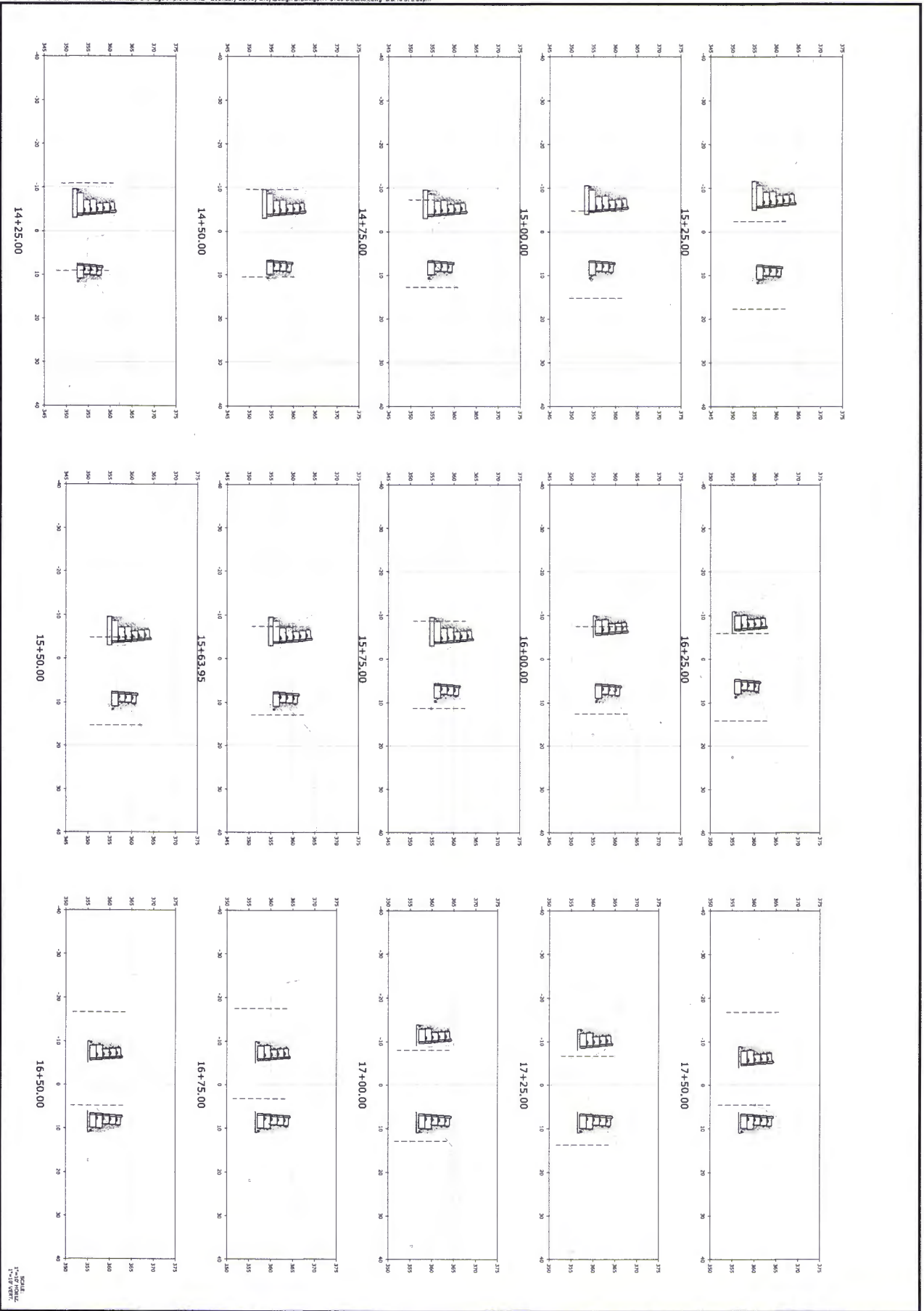

<p>ONE CALL 811</p> <p>Know what's below. Call before you dig.</p>	<p>PRINCETON & MONCLAIR DRAINAGE IMPROVEMENTS BENTON, ARKANSAS</p>	<p>MCE McCLELLAND CONSULTING ENGINEERS, INC.</p> <p>1810 N. College 7302 Lewis Rd. 4006 S. Center Rd., Ste. 407 Fayetteville, AR 72702 Little Rock, AR 72204 Tulsa, OK 74146 P.O. Box 2000 P.O. Box 110000 P.O. Box 100000 (501) 772-1111 (501) 772-1111 (918) 436-8800</p> <p>http://www.mce.us.com</p>	<p>DATE: JAN 2018 DRAWN BY: [Name] CHECKED BY: [Name] SCALE: AS SHOWN 1" = 10' VERT. 1" = 40' HORIZ.</p>								
<p>20</p>	<p>CROSS SECTIONS STA. 14+25.00 TO STA. 17+50.00</p>	<table border="1" style="width: 100%; border-collapse: collapse;"> <thead> <tr> <th>NO.</th> <th>DATE</th> <th>REVISIONS</th> <th>DESCRIPTION</th> </tr> </thead> <tbody> <tr> <td> </td> <td> </td> <td> </td> <td> </td> </tr> </tbody> </table>	NO.	DATE	REVISIONS	DESCRIPTION					<p>SCALE: 1" = 10' VERT. 1" = 40' HORIZ.</p>
NO.	DATE	REVISIONS	DESCRIPTION								

CEMWK-OD-FE KWH-MVK-2018-233
MR. TONY FLOYD
BENTON STREET DEPARTMENT

M:\2017\15128-Benton Street Drainage and Sewerage Improvements - Bentley - Sewer Only\Drawings\Drawings\15128-05-000.dwg 28'x18 @ 1/32"

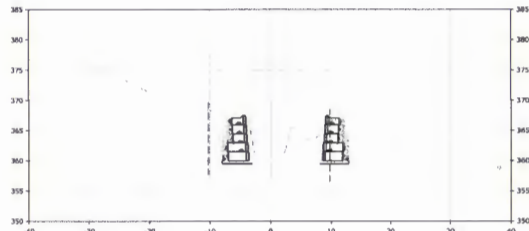

18+75.00

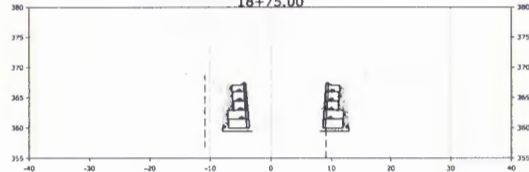

18+50.00

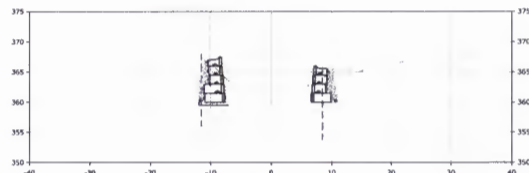

18+25.00

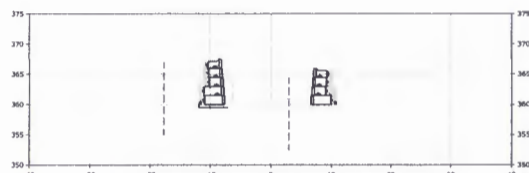

18+00.00

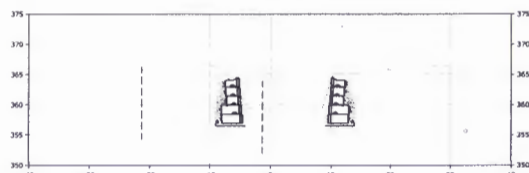

17+75.00

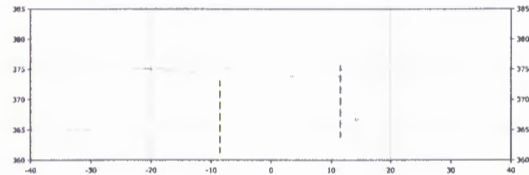

20+00.00



19+75.00

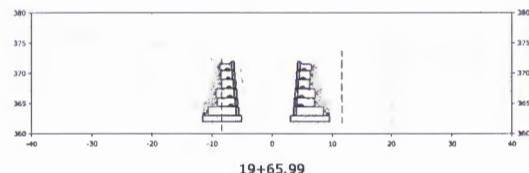

19+65.99

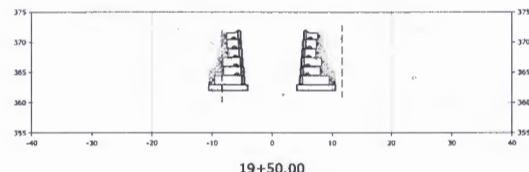

19+50.00

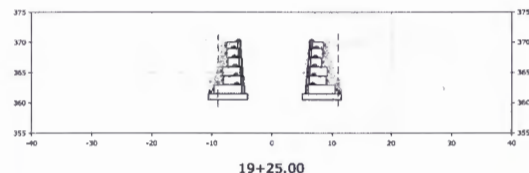

19+25.00

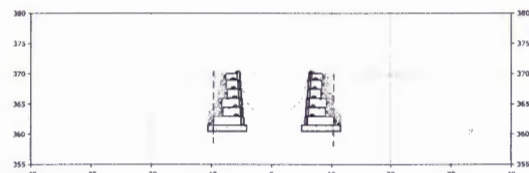

19+00.00

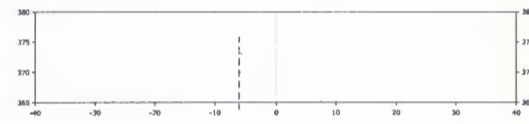

21+22.68

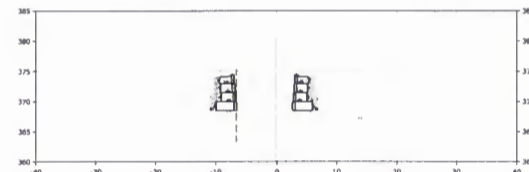

21+00.00

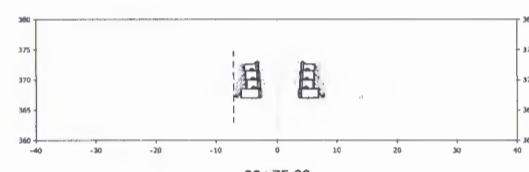

20+75.00

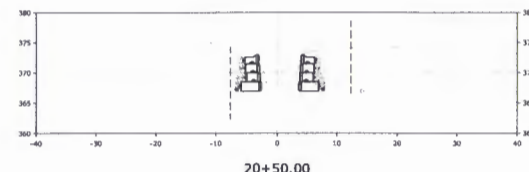

20+50.00

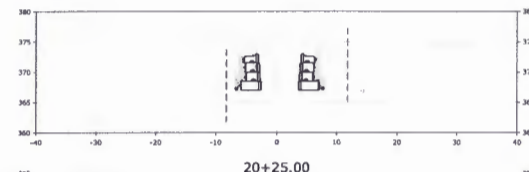

20+25.00

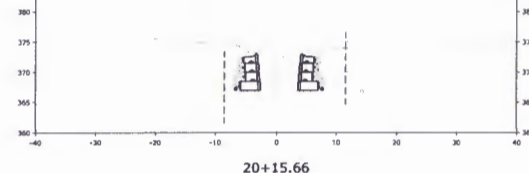

20+15.66

MCE McCLELLAND
 CONSULTING
 ENGINEERS, INC.
 1001 N. LAMAR, SUITE 200
 BENTON, ARKANSAS 72015-1400
 PHONE: 501-752-2277
 FAX: 501-752-2278
 http://www.mce.usa.com

ORIGINAL DIMENSIONS ON FILE

PRINCETON & MONTCLAIR
 DRAINAGE IMPROVEMENTS
 BENTON, ARKANSAS

One Call
811
 Know what's below.
 Call before you dig.

NO.	DATE	REVISION	DESCRIPTION

CROSS SECTIONS
 STA. 17+75.00
 TO STA. 21+22.68

PREPARED BY: RB
 CHECKED BY: JAM
 DATE: JAN 2018
 SCALE: AS SHOWN (L&T: 5/64)

SCALE:
 1" = 10' HORIZ.
 1" = 10' VERT.

CEMVK-OD-FE KWH-MVK-2018-233

MR. TONY FLOYD
 BENTON STREET DEPARTMENT