



**US Army Corps  
of Engineers**

Vicksburg District  
4155 Clay Street  
Vicksburg, MS 39183-3435  
www.mvk.usace.army.mil



# Public Notice

|                  |                              |
|------------------|------------------------------|
| APPLICATION NO.: | MVK-2013-1001                |
| EVALUATOR:       | Ms. Kristi Hall              |
| PHONE NO.:       | (601) 631-7528               |
| FAX NO.:         | (601) 631-5459               |
| E-MAIL:          | Kristi.W.Hall@usace.army.mil |
| DATE:            | October 19, 2015             |
| EXPIRATION DATE: | November 9, 2015             |

Interested parties are hereby notified that the U.S. Army Corps of Engineers, Vicksburg District is considering an application for a Department of the Army permit for the work described herein. Comments should be forwarded to the Vicksburg District, Attention: CEMVK-OD-F, 4155 Clay Street, Vicksburg, Mississippi 39183-3435.

Application also has been made to the Louisiana Department of Environmental Quality, Office of Environmental Services for a Water Quality Certification in accordance with La. R.S. 30.2074(A)(93), and Section 401 of the Clean Water Act (P.L. 95-217). Additional information is on file with the above office, and may be inspected at any time between 8:00 a.m. and 4:30 p.m. weekdays. Copies may be obtained upon payment of cost of copying. Comments concerning the application can be filed with the Office of Environmental Services within 20 days of this notice to the following address: Office of Environmental Services, Post Office Box 4313, Baton Rouge, Louisiana 70821-4313.

Law Requiring a Permit: Section 404 of the Clean Water Act (33 U.S.C. 1344), which applies to discharges of dredged or fill material into waters of the United States.

Name of Applicant:  
Mr. Charles Williams  
St. Tammany Parish Government  
Post Office Box 628  
Covington, Louisiana 70434

Name of Agent:  
Mr. Thomas K. Brown  
Biological Surveys, Incorporated  
Post Office Box 94  
Covington, Louisiana 70434

Location of Work: Sections 17, 18 and 37, T9S- R15E, Latitude 30.2903, Longitude -89.7424, within the Pearl River Drainage Basin (8-digit USGS HUC 03180004), St. Tammany Parish, Louisiana.

**Description of Work:** (See enclosed map and drawings.)

The following descriptions of the proposed project and associated impacts are based upon information provided by the applicant.

The applicant is applying for a Department of the Army permit to conduct regulated activities in jurisdictional wetlands for the purpose of constructing a 54-acre detention pond as well as widening and deepening approximately 1.4 miles of the W-15 (French Branch) Canal. The applicant's stated purpose is for drainage improvements and flood abatement.

Approximately 340,000 cubic yards of borrow material would be removed from the project area. This material would be hauled to an offsite location. Approximately 20.93 acres of wetlands would be excavated, and 0.49 acres would be filled.

The vegetative communities within the project area can best be described as mixed hardwood/pine and are dominated by Slash pine, Loblolly pine, Water oak, Post oak, Black Tupelo, Sweet bay, Youpon, Gallberry, Chinese tallow and Southern bayberry. Soils within the project area are primarily Myatt fine sandy loam, and Stough fine sandy loam, having a respective hydric component percent rating of 90 and 10 by the Natural Resource Conservation Service (NRCS).

The applicant proposes to mitigate for the unavoidable loss of jurisdictional impacts through permittee responsible mitigation. Impacts below the 5-foot contour would be mitigated at a commercial mitigation bank, approved for coastal impacts by the Louisiana Office of Coastal Management.

Upon reviewing this notice, you should write to this office to provide your opinion of the impacts this work would have on the natural and human environment and address any mitigation you believe is necessary to offset these impacts. Other comments are welcome, but the above information would further our review of the applicant's plan as proposed. Comments of a general nature are not as helpful as those specific to the impacts of the subject project.

**State Water Quality Permit:** The State Pollution Control Agency must certify that the described work would comply with the State's water quality standards and effluent limitations before a Corps permit is issued.

**Cultural Resources:** The Regulatory Archaeologist has reviewed the latest published version of the National Register of Historic Places, state lists of properties determined eligible, and other sources of information. The following is current knowledge of the presence or absence of historic properties and the effects of the proposed undertaking upon these properties. No known historic



properties exist in the proposed permit area. Copies of the public notice have been sent to Federally recognized Tribes and other interested parties for comment on potential effects to historic properties that could result from the proposed activity.

**Endangered Species:** Based on the Standard Local Operating Procedure for Endangered Species (SLOPES) as signed on December 1, 2014 between the U.S. Army Corps of Engineers, Vicksburg District and the U.S. Fish and Wildlife Service, it has been determined that the proposed activity would have no effect on the following species: West Indian Manatee, Red-cockaded Woodpecker. Our initial finding is that the proposed work would not affect the following species or their critical habitats: Sprague's pipit, Louisiana Quillwork, Atlantic Sturgeon. It has been determined that the proposed activity is not likely to adversely affect the following species: Dusky gopher frog and Alabama heelsplitter mussel. Based on SLOPES, it has been determined that the project is not likely to adversely affect the Ringed map turtle. Further coordination with the U.S. Fish and Wildlife Service would be conducted as part of the permit review process.

**Flood Plain:** In accordance with 44 CFR Part 60 (Flood Plain Management and Use), participating communities are required to review all proposed development to determine if a flood plain development permit is required. Flood plain administrators should review the proposed development described in this public notice and apprise this office of any flood plain development permit requirements. The project is completely located within the 100 year floodplain.

**Evaluation Factors:** The decision whether or not to issue a permit would be based upon an evaluation of the probable impact of the proposed activity on the public interest. That decision would reflect the national concern for both protection and utilization of important resources. The benefits which may be expected to accrue from the proposal must be balanced against its expected adverse effects. All factors which may be relevant to the proposal would be considered; among these are conservation, economics, aesthetics, general environmental concerns, historic values, fish and wildlife values, flood damage prevention, land use classification, navigation, recreation, water supply, water quality, energy needs, safety, food requirements and, in general, the needs and welfare of the people. Evaluation of the proposed activity would include application of the guidelines published by the Environmental Protection Agency under authority of Section 404(b) of the Clean Water Act.

**Public Involvement:** The purpose of this notice is to solicit comments from the public; Federal, State, and local agencies and officials; Indian Tribes; and other interested parties. These comments would be used to evaluate the impacts of this project. All comments would be considered and used to help determine whether to issue the permit, deny the permit, or issue the permit with conditions,

and to help us determine the amount and type of mitigation necessary. This information would be used in our Environmental Assessment or Impact Statement. Comments are also used to determine the need for a public hearing.

**Opportunity for a Public Hearing:** Any person may make a written request for a public hearing to consider this permit application. This request must be submitted by the public notice expiration date and must clearly state why a hearing is necessary. Failure of any agency or individual to comment on this notice would be interpreted to mean that there is no objection to the proposed work. Please bring this announcement to the attention of anyone you know who might be interested in this matter.

**Notification of Final Permit Actions:** Each month, the final permit actions from the preceding month are published on the Vicksburg District Regulatory web page. To access this information, you may follow the link from the Regulatory web page, <http://www.mvk.usace.army.mil/Missions/Regulatory.aspx>.

*Thomas A. McCabe*  
Thomas A. McCabe  
Acting, Evaluation Chief  
Regulatory Branch



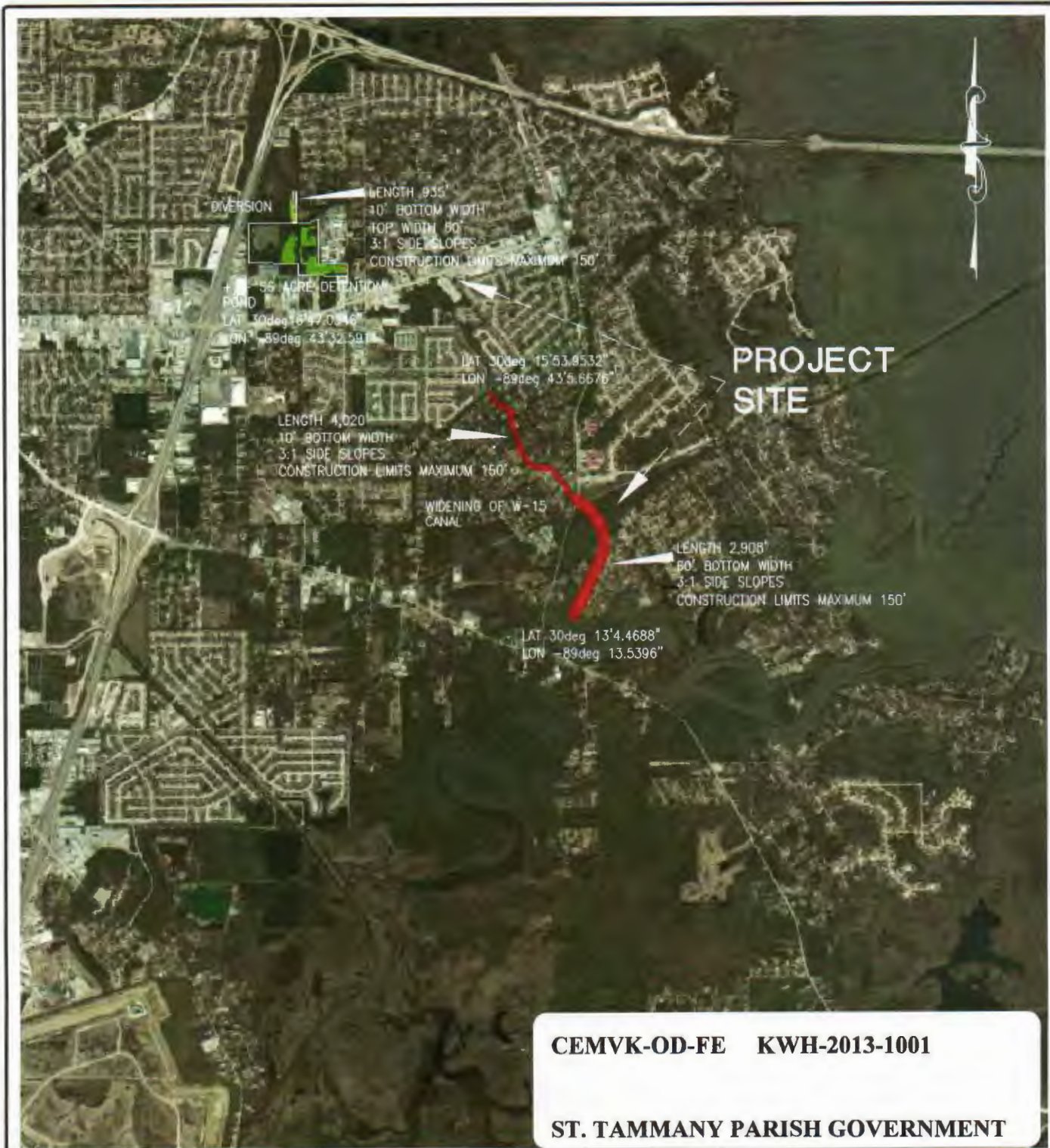

**CEMVK-OD-FE KWH-2013-1001**

**ST. TAMMANY PARISH GOVERNMENT**



**DUPLANTIS DESIGN GROUP, PC**  
 CIVIL ENGINEERING \* ARCHITECTURE

34 LOUIS PRIMA DRIVE COVINGTON, LA 70433  
 PHONE: 985-249-6180 || FAX: 985-249-6190

WWW.DDGPC.COM

THIBODAUX \ COVINGTON \ HOUSTON \ BATON ROUGE \ HOUMA

**1. VICINITY MAP**  
**TENET POND & LOWER FRENCH BRANCH (W-15)**  
**FRENCH BRANCH DRAINAGE PROJECT**  
**SLIDELL, LA**  
**ST. TAMMANY PARISH, LA**

DATE: 5-12-15



ST. TAMMANY PARISH GOVERNMENT

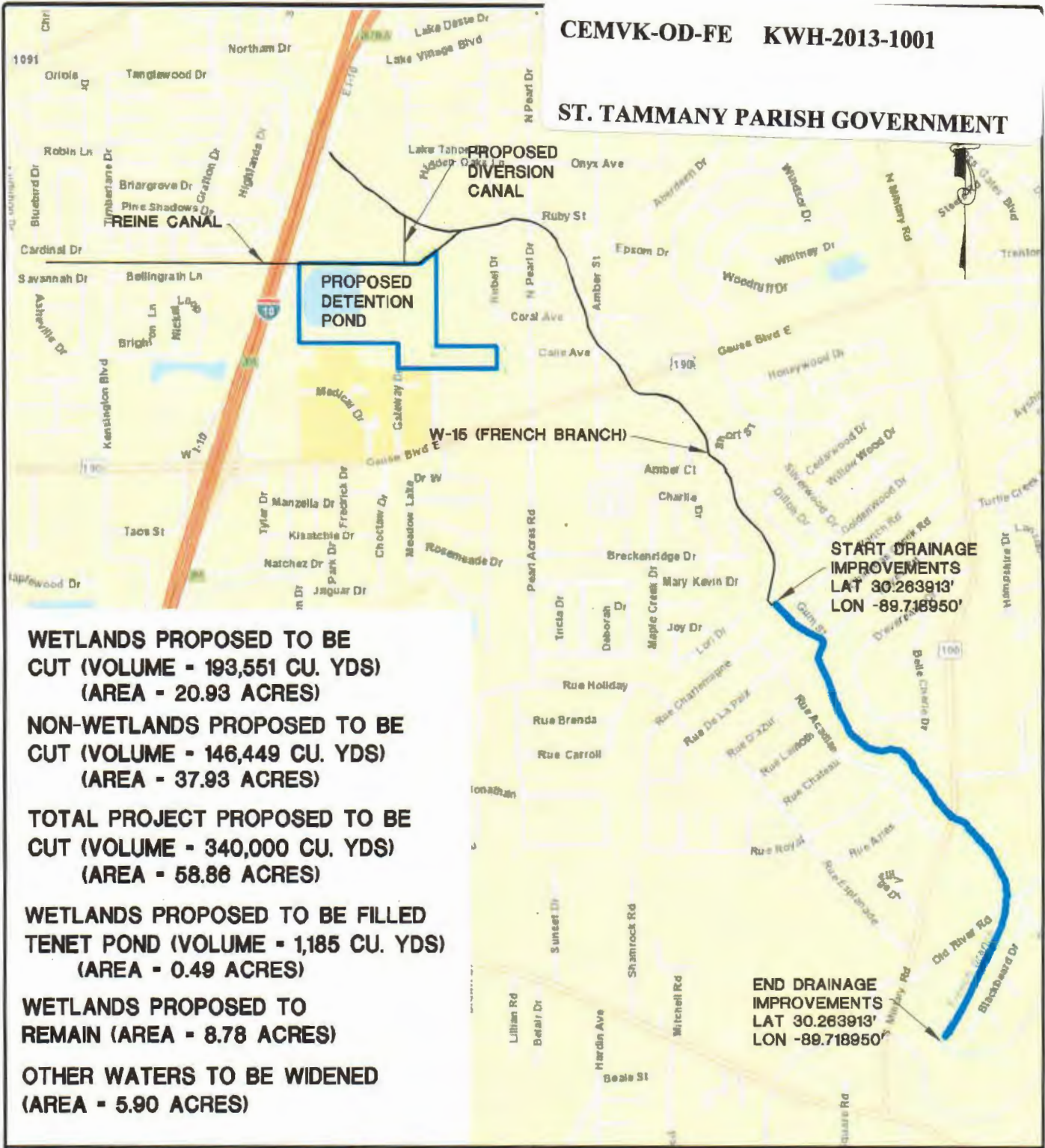

**WETLANDS PROPOSED TO BE CUT (VOLUME - 193,551 CU. YDS)  
(AREA - 20.93 ACRES)**

**NON-WETLANDS PROPOSED TO BE CUT (VOLUME - 146,449 CU. YDS)  
(AREA - 37.93 ACRES)**

**TOTAL PROJECT PROPOSED TO BE CUT (VOLUME - 340,000 CU. YDS)  
(AREA - 58.86 ACRES)**

**WETLANDS PROPOSED TO BE FILLED  
TENET POND (VOLUME - 1,185 CU. YDS)  
(AREA - 0.49 ACRES)**

**WETLANDS PROPOSED TO REMAIN (AREA - 8.78 ACRES)**

**OTHER WATERS TO BE WIDENED  
(AREA - 5.90 ACRES)**

**DDG** DUPLANTIS DESIGN GROUP, PC  
CIVIL ENGINEERING \* ARCHITECTURE  
34 LOUIS PRIMA DRIVE COVINGTON, LA 70433  
WWW.DDGPC.COM PHONE: 985.249.6180 || FAX: 985.249.6190  
THIBODAUX | COVINGTON | HOUSTON | BATON ROUGE | HOUMA

**2. AREA AND VOLUMES  
TENET POND & LOWER FRENCH BRANCH (W-15)  
FRENCH BRANCH DRAINAGE PROJECT  
SLIDELL, LA  
ST. TAMMANY PARISH, LA  
DATE: 5-12-15**





**NOTE: W-15 (OTHER WATERS)  
TO BE WIDENED**

**CEMVK-OD-FE KWH-2013-1001**

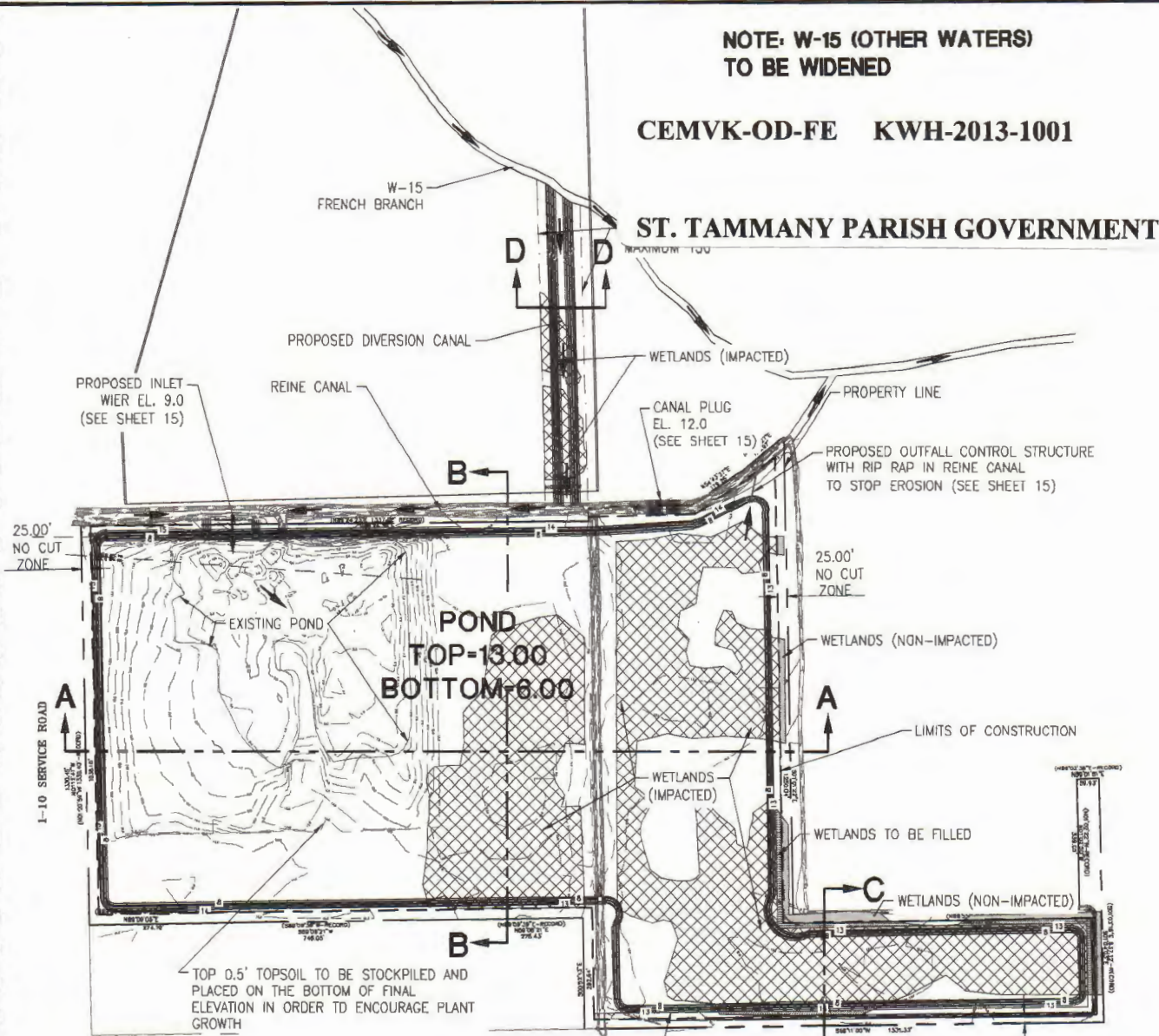
**ST. TAMMANY PARISH GOVERNMENT**

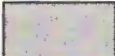

-  **WETLANDS PROPOSED TO BE CUT (CUT - 175,305 CU.YD.)**
-  **WETLANDS TO REMAIN**
-  **WETLANDS PROPOSED TO BE FILLED (FILLED - 1,185 CU.YD.)**

**SITE &  
GRADING PLAN**

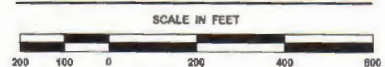

**TOTAL PROJECT AREA - 155.14 ACRES**

**DDG**  
**DUPLANTIS DESIGN GROUP, PC**  
 CIVIL ENGINEERING \* ARCHITECTURE  
 34 LOUIS PRIMA DRIVE COVINGTON, LA 70433  
 WWW.DDGPC.COM PHONE: 985.626.9547 || FAX: 985.626.0269  
 THIBODAUX \ COVINGTON \ HOUSTON \ BATON ROUGE \ HOUMA

**3. GRADING PLAN**  
**TENET POND & LOWER FRENCH BRANCH (W-15)**  
**FRENCH BRANCH (W-15) DRAINAGE PROJECT**  
**SECTION 1, TOWNSHIP 9S, RANGE 14E**  
**ST. TAMMANY PARISH, LA**

DATE: 5-12-15      UPDATED: 10-14-15





NOTE: W-15 (OTHER WATERS)  
TO BE WIDENED

CEMVK-OD-FE KWH-2013-1001

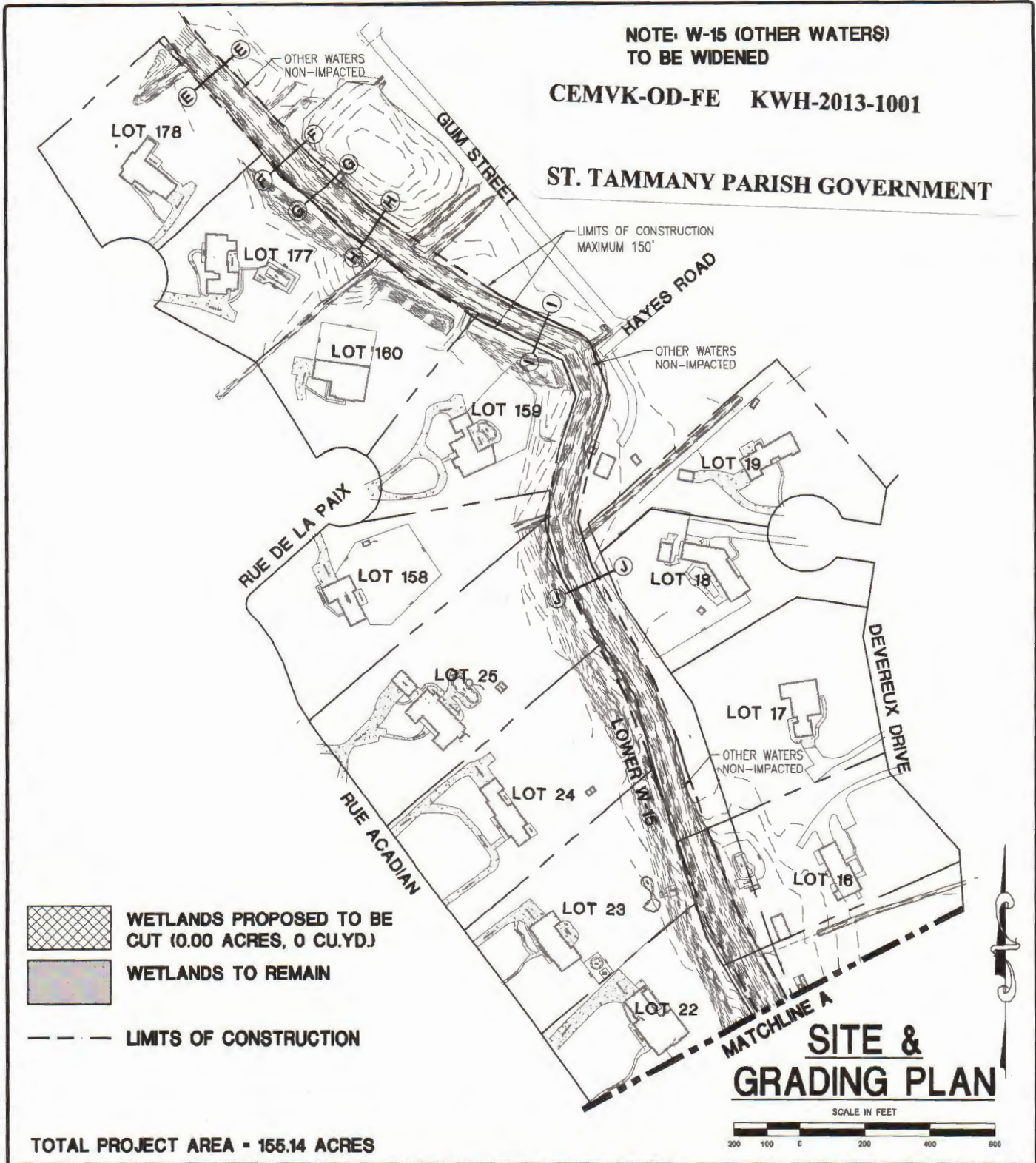
ST. TAMMANY PARISH GOVERNMENT



-  WETLANDS PROPOSED TO BE CUT (0.00 ACRES, 0 CU.YD.)
-  WETLANDS TO REMAIN
-  LIMITS OF CONSTRUCTION

TOTAL PROJECT AREA = 155.14 ACRES

**SITE & GRADING PLAN**

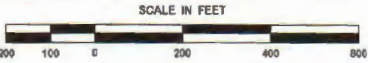

**DDG**  
 WWW.DDGPC.COM  
 THIBODAUX \ COVINGTON \ HOUSTON \ BATON ROUGE \ HOUMA

**DUPLANTIS DESIGN GROUP, PC**  
 CIVIL ENGINEERING • ARCHITECTURE  
 34 LOUIS PRIMA DRIVE COVINGTON, LA 70433  
 PHONE: 985.626.9547 \ FAX: 985.626.0269

**4. GRADING PLAN**  
**TENET POND & LOWER FRENCH BRANCH (W-15)**  
**FRENCH BRANCH (W-15) DRAINAGE PROJECT**  
**SECTION 37, TOWNSHIP 9S, RANGE 15E**  
**ST. TAMMANY PARISH, LA**

DATE: 5-12-15      UPDATED: 10-14-15



NOTE: W-15 (OTHER WATERS)  
TO BE WIDENED

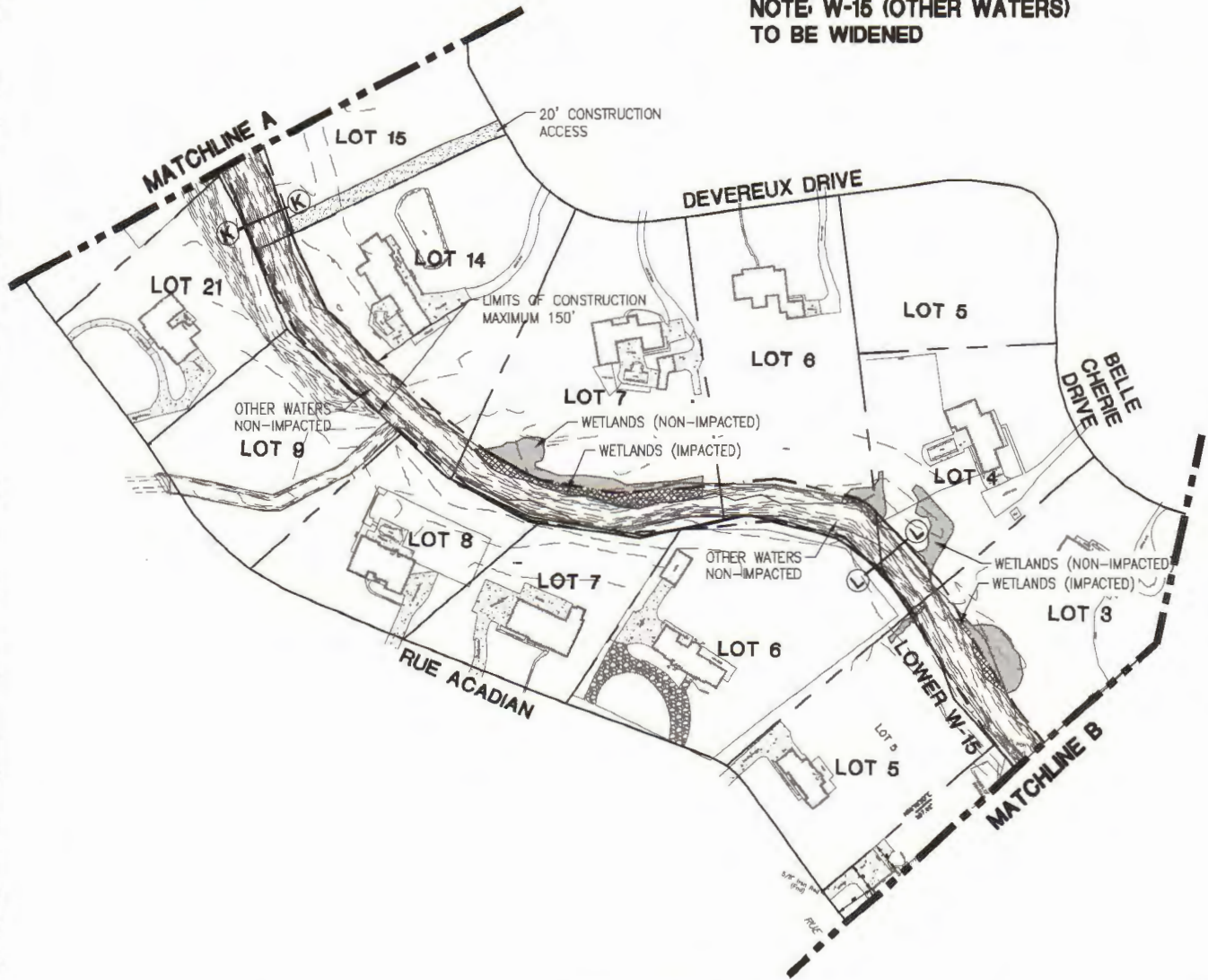



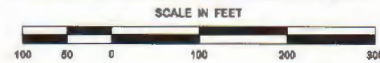

CEMVK-OD-FE KWH-2013-1001

ST. TAMMANY PARISH GOVERNMENT

### SITE & GRADING PLAN



-  WETLANDS PROPOSED TO BE CUT (0.18 ACRES, 182 CU.YD.)
-  WETLANDS TO REMAIN (0.28 ACRES)
-  LIMITS OF CONSTRUCTION
-  20' CONSTRUCTION ACCESS

TOTAL PROJECT AREA = 155.14 ACRES

**DDG** DUPLANTIS DESIGN GROUP, PC  
CIVIL ENGINEERING \* ARCHITECTURE  
34 LOUIS PRIMA DRIVE COVINGTON, LA 70433  
WWW.DDGPC.COM PHONE: 985.626.9547 || FAX: 985.626.0269  
THIBODAUX \ COVINGTON \ HOUSTON \ BATON ROUGE \ HOUMA



5. GRADING PLAN  
TENET POND & LOWER FRENCH BRANCH (W-15)  
FRENCH BRANCH (W-15) DRAINAGE PROJECT  
SECTION 37, TOWNSHIP 9S, RANGE 15E  
ST. TAMMANY PARISH, LA

DATE: 5-12-15 UPDATED: 10-14-15

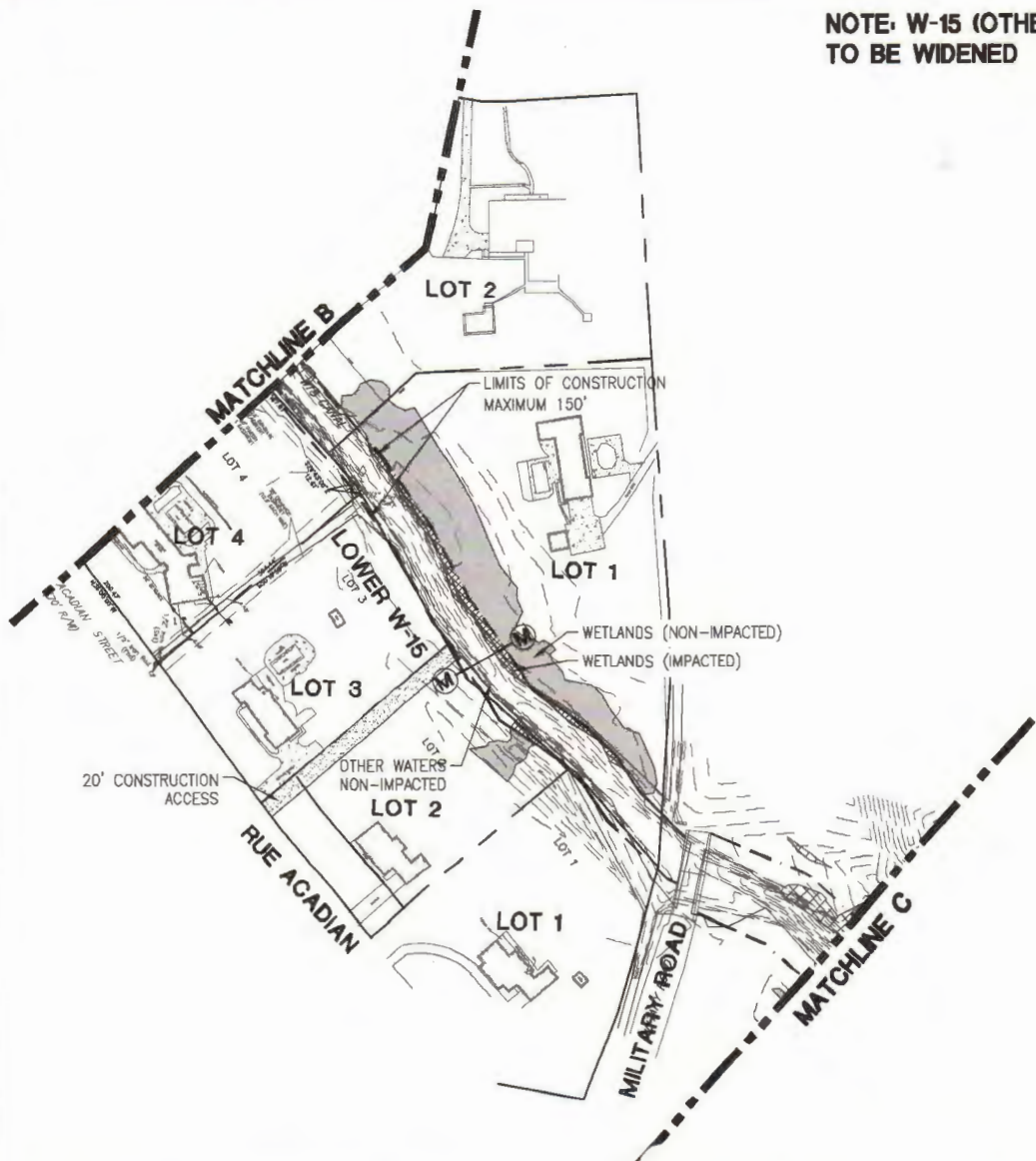

NOTE: W-15 (OTHER WATERS)  
TO BE WIDENED

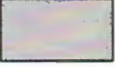

-  WETLANDS PROPOSED TO BE CUT (0.10 ACRES, 98 CU.YD.)
-  WETLANDS TO REMAIN (0.85 ACRES)
-  LIMITS OF CONSTRUCTION
-  20' CONSTRUCTION ACCESS

TOTAL PROJECT AREA - 155.14 ACRES

CEMVK-OD-FE KWH-2013-1001

ST. TAMMANY PARISH GOVERNMENT

## SITE & GRADING PLAN



**DDG** DUPLANTIS DESIGN GROUP, PC  
 CIVIL ENGINEERING • ARCHITECTURE  
 34 LOUIS PRIMA DRIVE COVINGTON, LA 70433  
 PHONE: 985.626.9547 || FAX: 985.626.0269  
 WWW.DDGPC.COM  
 THIBODAUX \ COVINGTON \ HOUSTON \ BATON ROUGE \ HOUMA

**6. GRADING PLAN**  
**TENET POND & LOWER FRENCH BRANCH (W-15)**  
**FRENCH BRANCH (W-15) DRAINAGE PROJECT**  
**SECTION 37, TOWNSHIP, 92, RANGE 15E**  
**ST. TAMMANY PARISH, LA**

DATE: 2-12-15      UPDATED: 10-14-15



NOTE: W-15 (OTHER WATERS)  
TO BE WIDENED

CEMVK-OD-FE KWH-2013-1001

ST. TAMMANY PARISH GOVERNMENT

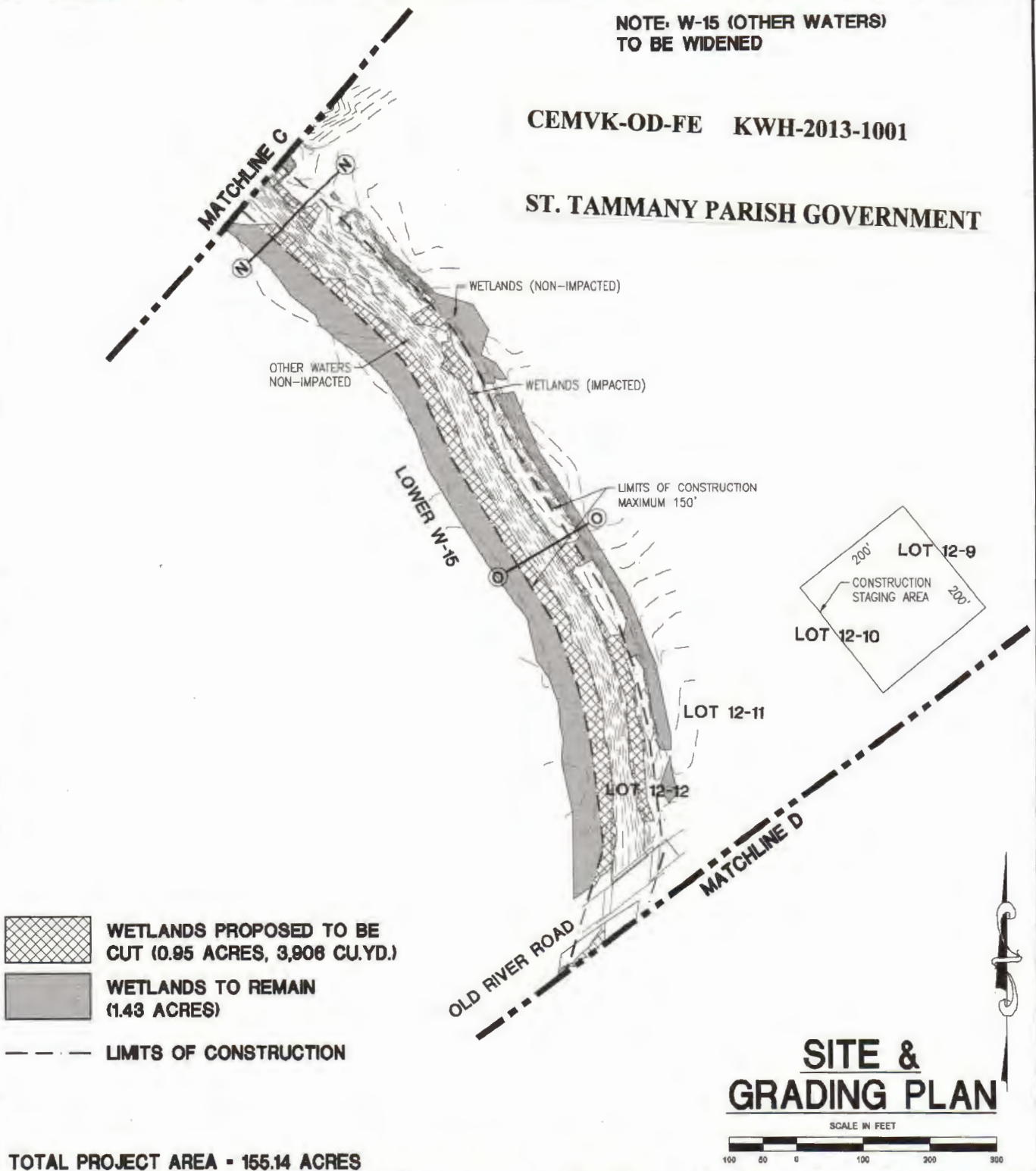

### SITE & GRADING PLAN

SCALE IN FEET

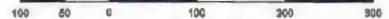

TOTAL PROJECT AREA - 155.14 ACRES



DUPLANTIS DESIGN GROUP, PC  
CIVIL ENGINEERING • ARCHITECTURE

34 LOUIS PRIMA DRIVE COVINGTON, LA 70433  
PHONE: 985.626.9547 || FAX: 985.626.0269

WWW.DDGPC.COM

THIBODAUX \ COVINGTON \ HOUSTON \ BATON ROUGE \ HOUMA

7. GRADING PLAN  
TENET POND & LOWER FRENCH BRANCH (W-15)  
FRENCH BRANCH (W-15) DRAINAGE PROJECT  
SECTION 17, TOWNSHIP 9S, RANGE 15E  
ST. TAMMANY PARISH, LA



DATE: 5-12-15

UPDATED: 10-14-15

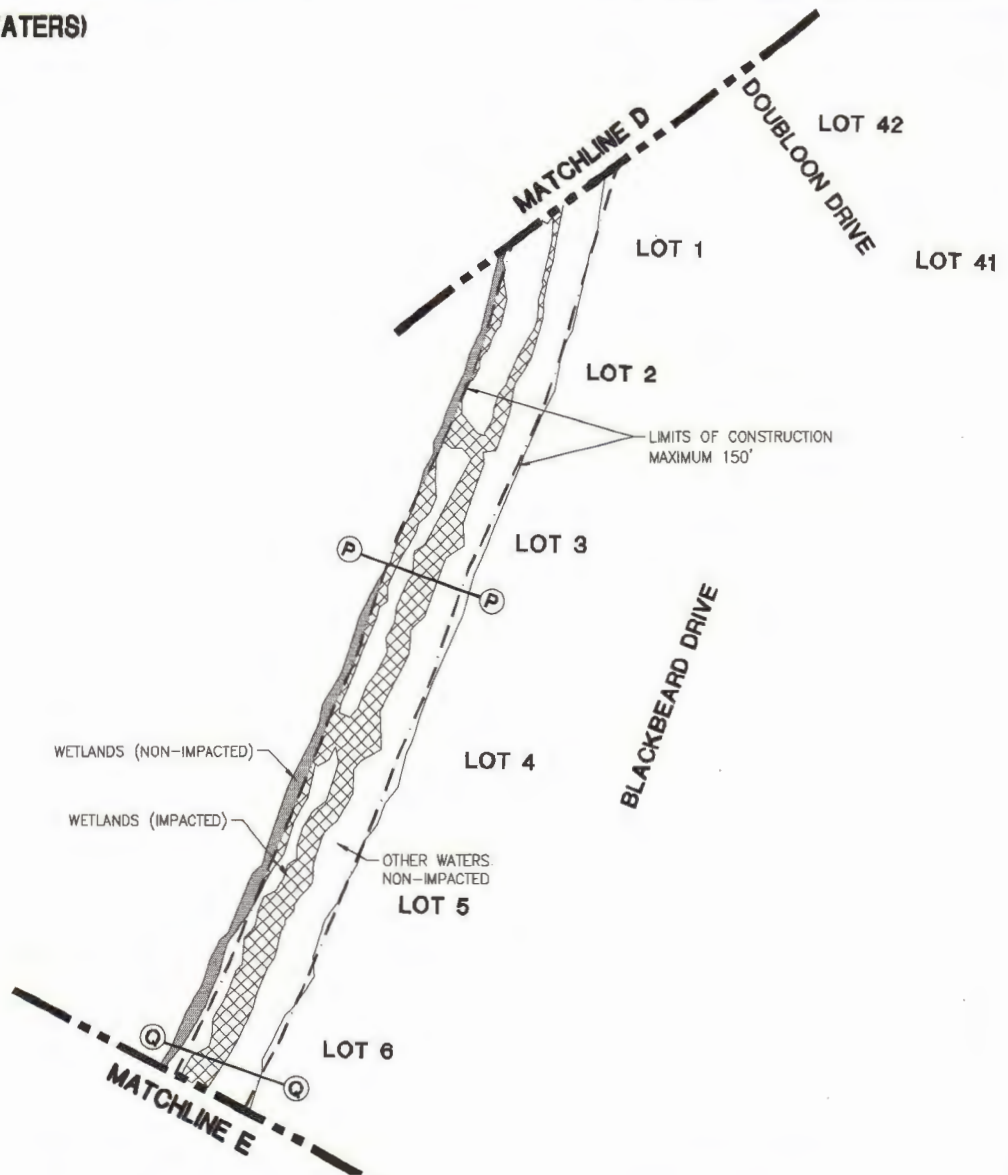

NOTE: W-15 (OTHER WATERS)  
TO BE WIDENED



-  WETLANDS PROPOSED TO BE CUT (0.82 ACRES, 7,030 CU.YD.)
-  WETLANDS TO REMAIN
-  LIMITS OF CONSTRUCTION

CEMVK-OD-FE KWH-2013-1001

ST. TAMMANY PARISH GOVERNMENT

## SITE & GRADING PLAN

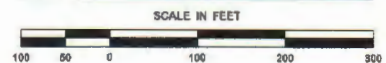

TOTAL PROJECT AREA - 155.14 ACRES

**DDG**  
 DUPLANTIS DESIGN GROUP, PC  
 CIVIL ENGINEERING \* ARCHITECTURE  
 34 LOUIS PRIMA DRIVE COVINGTON, LA 70433  
 WWW.DDGPC.COM PHONE: 985.626.9547 \ FAX: 985.626.0269  
 THIBODAUX \ COVINGTON \ HOUSTON \ BATON ROUGE \ HOUMA

8. GRADING PLAN  
 TENET POND & LOWER FRENCH BRANCH (W-15)  
 FRENCH BRANCH (W-15) DRAINAGE PROJECT  
 SECTION 17, TOWNSHIP 9S, RANGE 15E  
 ST. TAMMANY PARISH, LA

DATE: 5-12-15 UPDATED: 10-14-15



NOTE: W-15 (OTHER WATERS)  
TO BE WIDENED

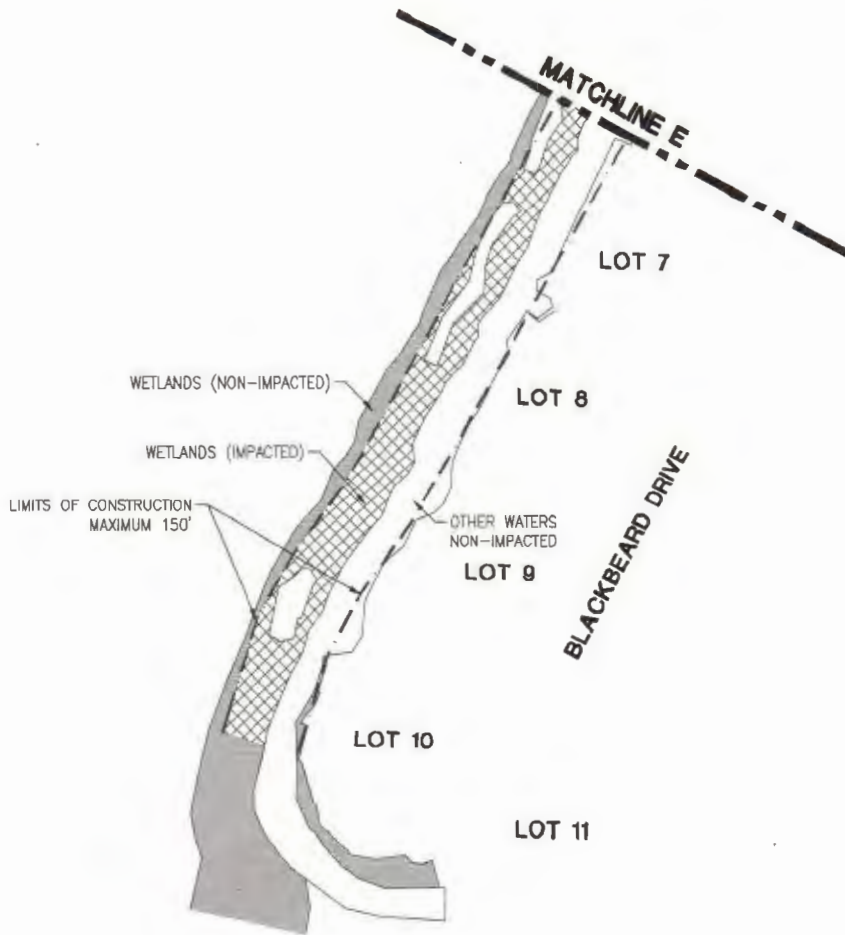

 WETLANDS PROPOSED TO BE CUT (0.82 ACRES, 7,030 CU.YD.)

 WETLANDS TO REMAIN

 LIMITS OF CONSTRUCTION

CEMVK-OD-FE KWH-2013-1001

ST. TAMMANY PARISH GOVERNMENT

**SITE &  
GRADING PLAN**

SCALE IN FEET



TOTAL PROJECT AREA - 155.14 ACRES

**DDG** DUPLANTIS DESIGN GROUP, PC  
CIVIL ENGINEERING \* ARCHITECTURE  
34 LOUIS PRIMA DRIVE COVINGTON, LA 70433  
PHONE: 985.626.9547 \ FAX: 985.626.0269  
WWW.DDGPC.COM  
THIBODAUX \ COVINGTON \ HOUSTON \ BATON ROUGE \ HOUMA

**9. GRADING PLAN**  
TENET POND & LOWER FRENCH BRANCH (W-15)  
FRENCH BRANCH (W-15) DRAINAGE PROJECT  
SECTION 17, TOWNSHIP 9S, RANGE 15E  
ST. TAMMANY PARISH, LA

DATE: 5-12-15

UPDATED: 10-14-15

CEMVK-OD-FE KWH-2013-1001

ST. TAMMANY PARISH GOVERNMENT

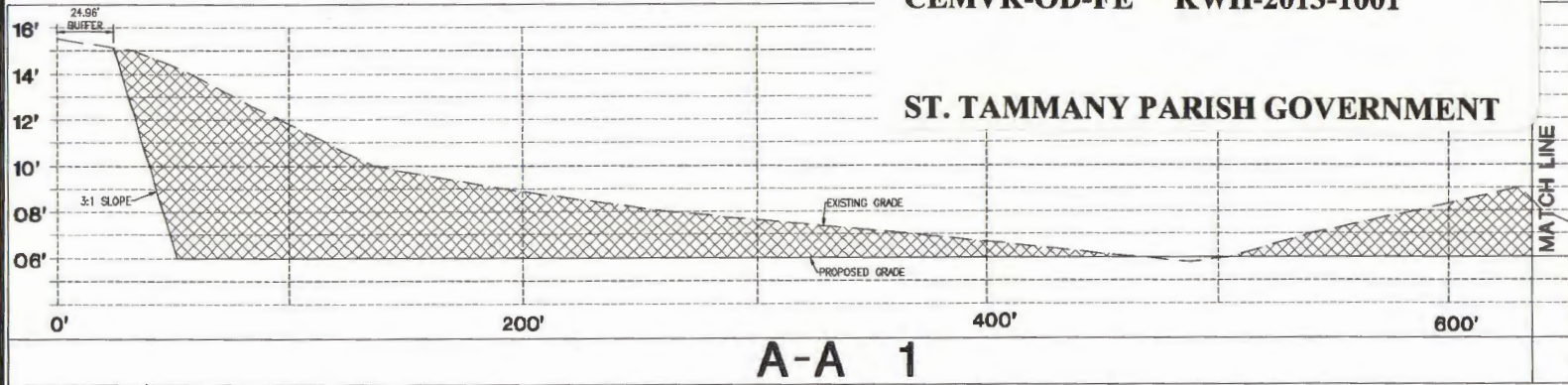

A-A 1

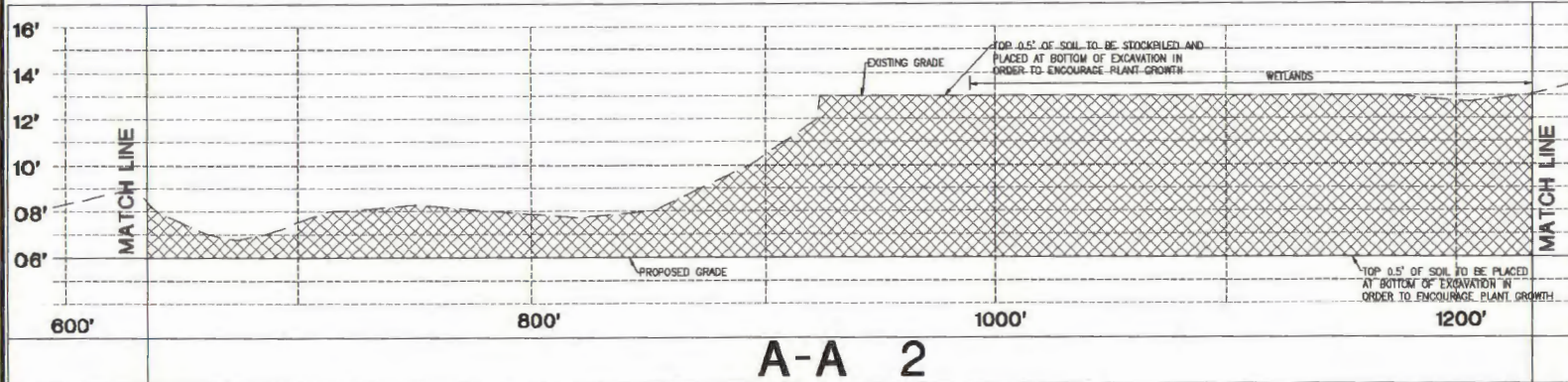

A-A 2

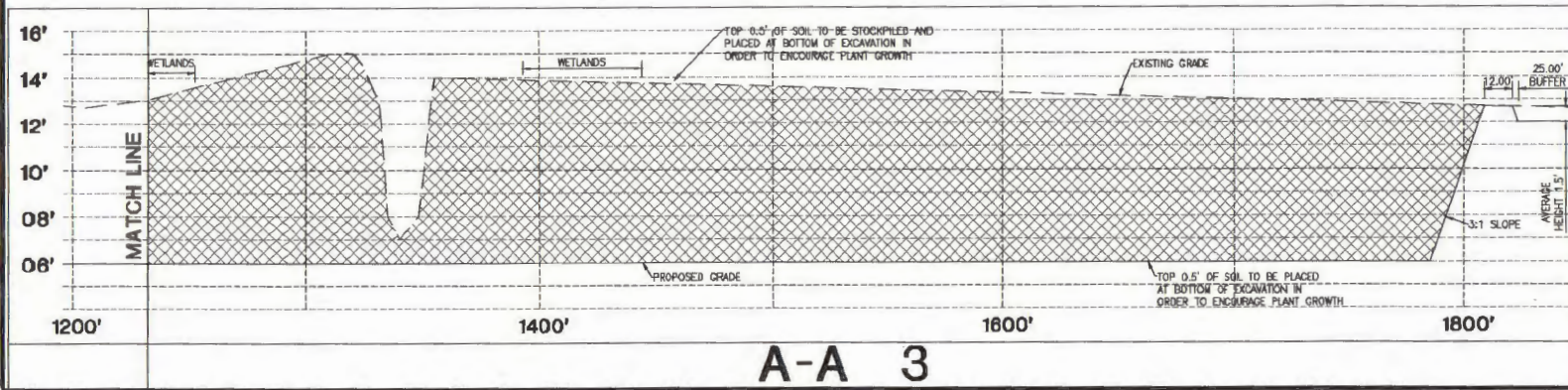

A-A 3

**10. CROSS SECTIONS**  
**TENET POND & LOWER FRENCH BRANCH (W-15)**  
**FRENCH BRANCH (W-15) DRAINAGE PROJECT**  
**SECTION 37, TOWNSHIP 9S, RANGE 15E**  
**ST. TAMMANY PARISH, LA**

DATE: 5-12-15

**DUPLANTIS DESIGN GROUP, PC**  
 CIVIL ENGINEERING - ARCHITECTURE  
 34 LOUIS PRIMA DRIVE COVINGTON, LA 70433  
 PHONE: 985.626.9547 || FAX: 985.626.0269  
 WWW.DDGPC.COM

**THIBODAUX | COVINGTON | HOUSTON | BATON ROUGE | HOUMA**



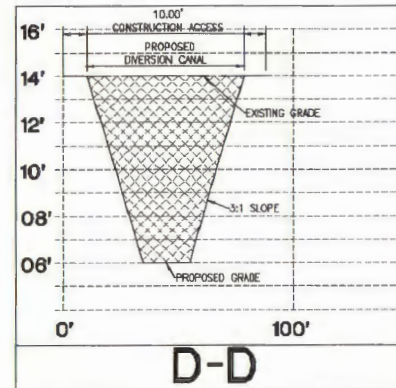
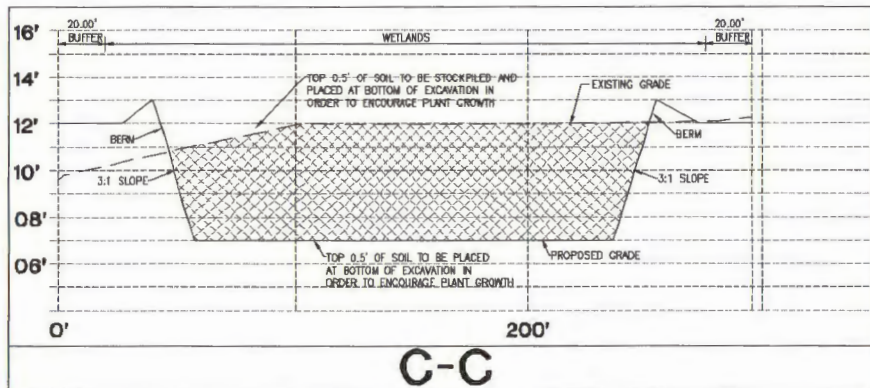
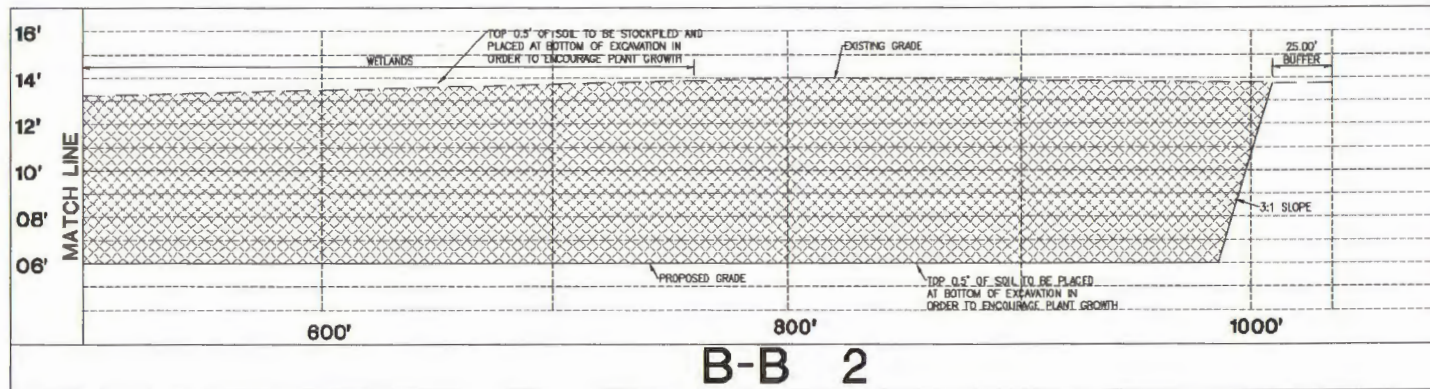
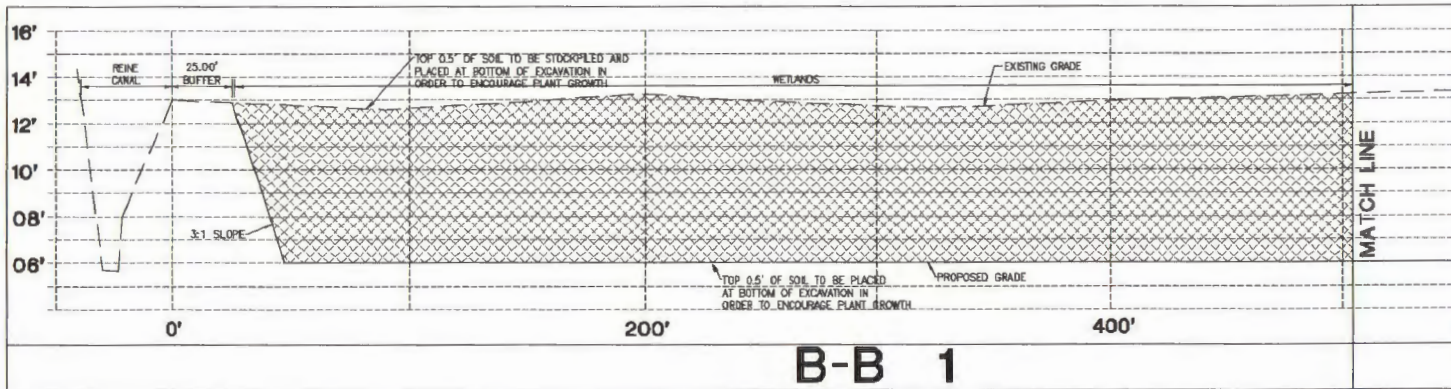

**DDG**  
 WWW.DDGPC.COM  
 THIBODAUX | COVINGTON | HOUSTON | BATON ROUGE | HOUMA

**DUPLANTIS DESIGN GROUP, PC**  
 CIVIL ENGINEERING + ARCHITECTURE  
 34 LOUIS PRIMA DRIVE COVINGTON, LA 70433  
 PHONE: 985.626.9547 || FAX: 985.626.0269

**11. CROSS SECTIONS**  
**TENET POND & LOWER FRENCH BRANCH (W-15)**  
**FRENCH BRANCH (W-15) DRAINAGE PROJECT**  
**SECTION 37, TOWNSHIP 9S, RANGE 15E**  
**ST. TAMMANY PARISH, LA**

DATE: 5-12-15

CEMVK-OD-FE KWH-2013-1001

ST. TAMMANY PARISH GOVERNMENT



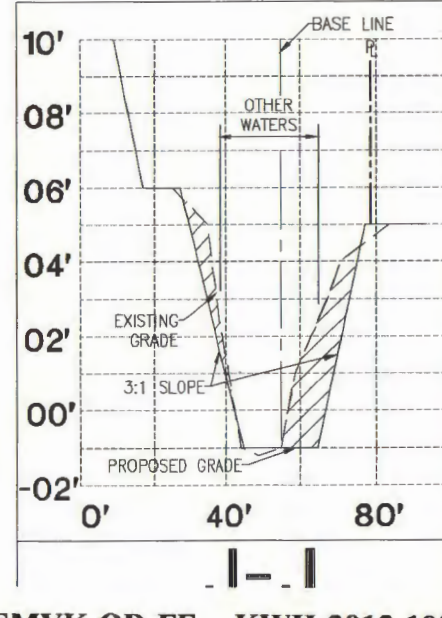
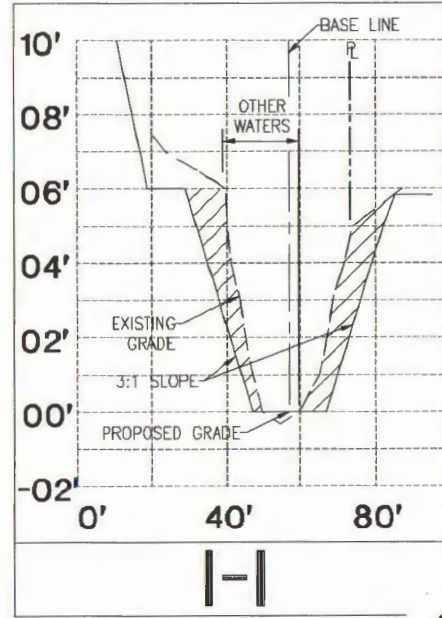
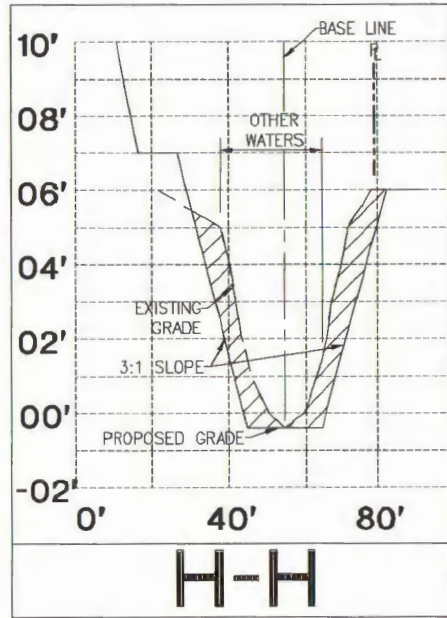
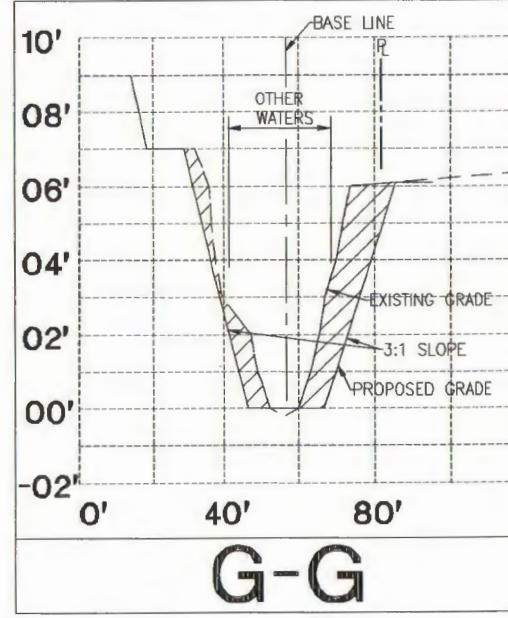
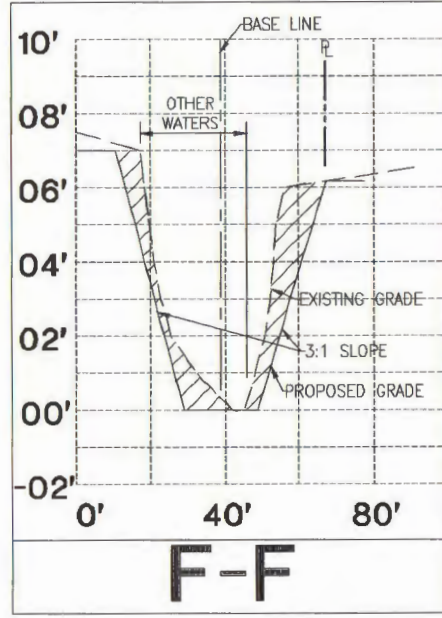
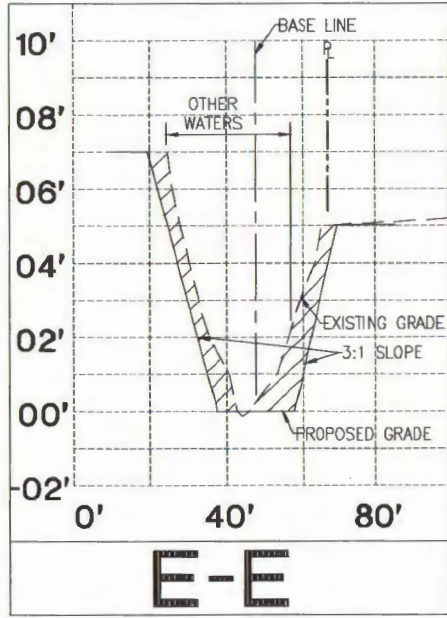

CEMVK-OD-FE KWH-2013-1001

ST. TAMMANY PARISH GOVERNMENT



**DUPLANTIS DESIGN GROUP, PC**  
CIVIL ENGINEERING + ARCHITECTURE

34 LOUIS PRIMA DRIVE COVINGTON, LA 70433  
PHONE: 985.626.9547 || FAX: 985.626.0269

WWW.DDGPC.COM

THIBODAUX \ COVINGTON \ HOUSTON \ BATON ROUGE \ HOUMA

**12. CROSS SECTIONS**  
**TENET POND & LOWER FRENCH BRANCH (W-15)**  
**FRENCH BRANCH (W-15) DRAINAGE PROJECT**  
**SECTION 37, TOWNSHIP 9S, RANGE 15E**  
**ST. TAMMANY PARISH, LA**

DATE: 5-12-15

M:\CAD\Dwg\11-000\11-143\Wetlands\11-143 Wetland Permit Grading Plan Exhibits.dwg



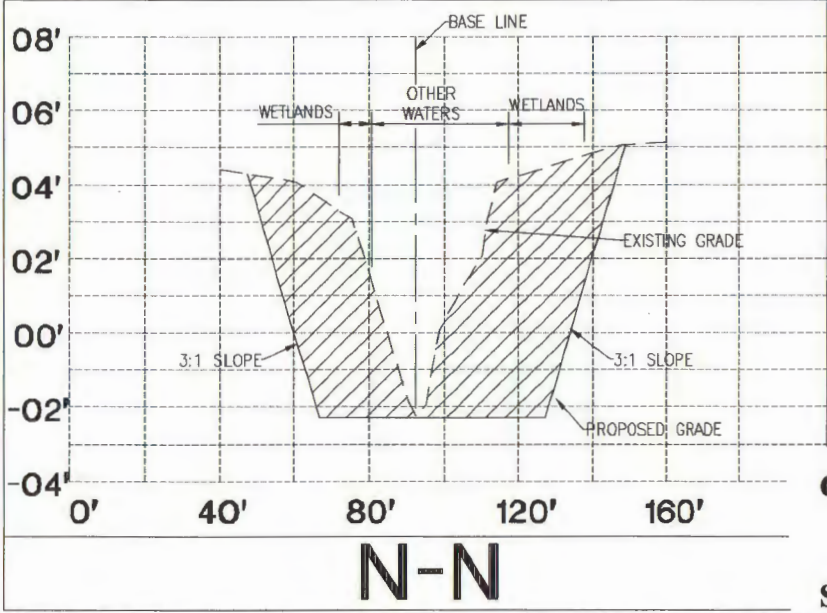
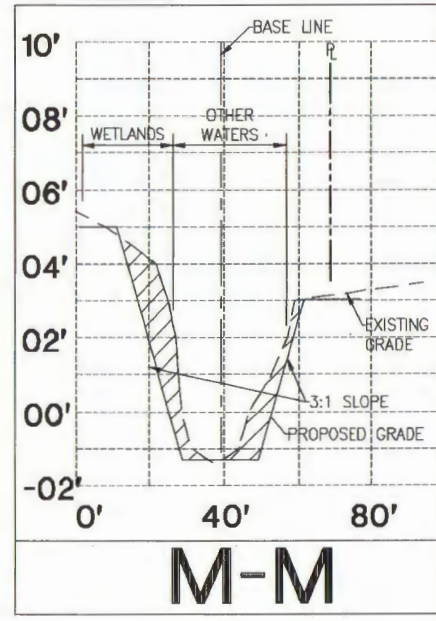
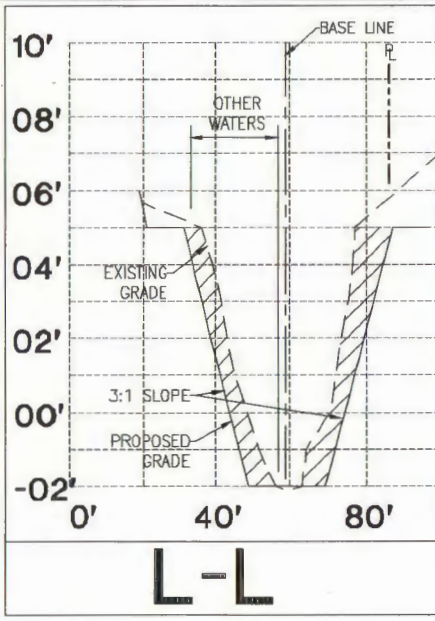
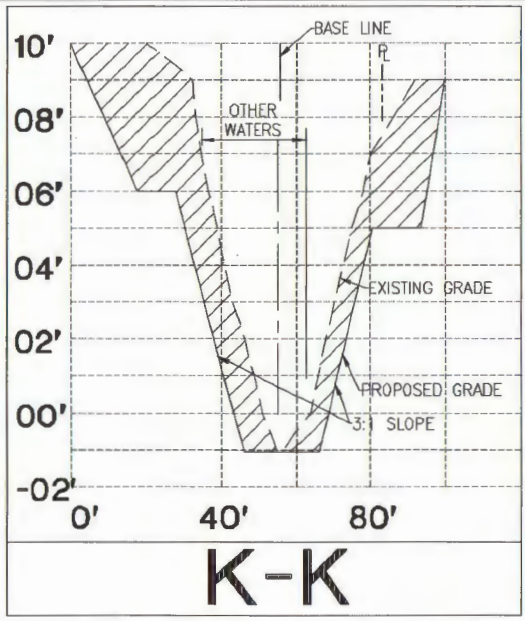

CEMVK-OD-FE KWH-2013-1001

ST. TAMMANY PARISH GOVERNMENT

**DDG**  
 WWW.DDGPC.COM  
 THIBODAUX | COVINGTON | HOUSTON | BATON ROUGE | HOUMA

**DUPLANTIS DESIGN GROUP, PC**  
 CIVIL ENGINEERING + ARCHITECTURE  
 34 LOUIS PRIMA DRIVE COVINGTON, LA 70433  
 PHONE: 985.626.9547 || FAX: 985.626.0269

**13. CROSS SECTIONS**  
**TENET POND & LOWER FRENCH BRANCH (W-15)**  
**FRENCH BRANCH (W-15) DRAINAGE PROJECT**  
**SECTION 37 & 17, TOWNSHIP 9S, RANGE 15E**  
**ST. TAMMANY PARISH, LA**

DATE: 5-12-15

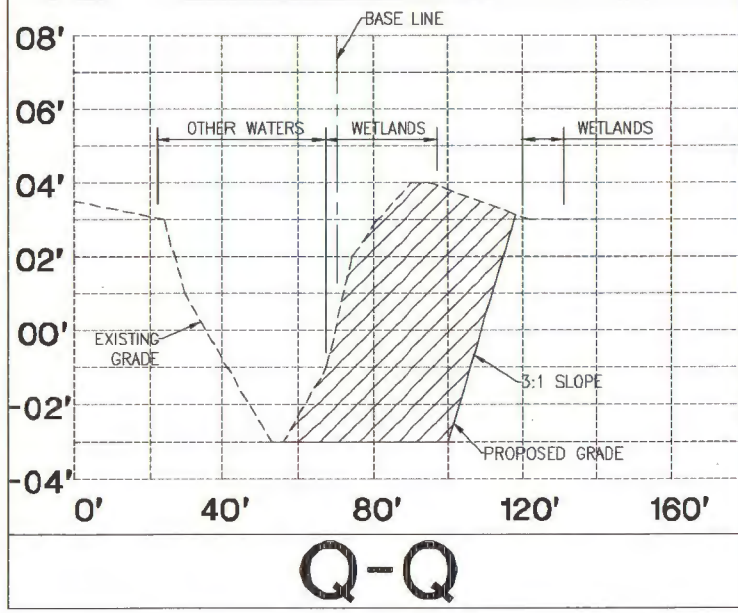
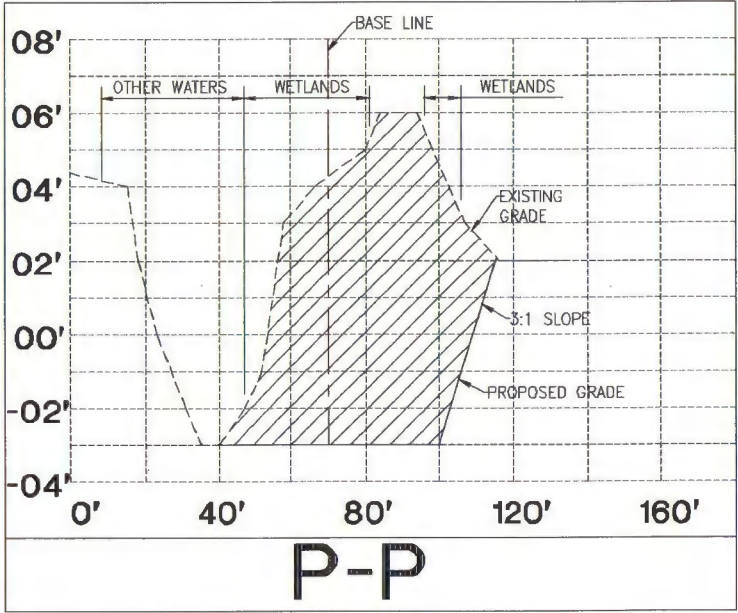
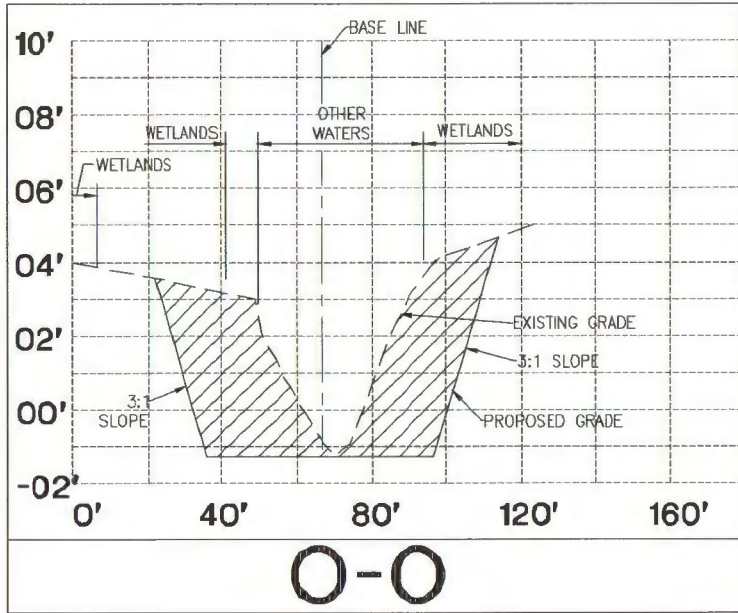

CEMVK-OD-FE KWH-2013-1001

ST. TAMMANY PARISH GOVERNMENT

**14. CROSS SECTIONS**  
**TENET POND & LOWER FRENCH BRANCH (W-15)**  
**FRENCH BRANCH (W-15) DRAINAGE PROJECT**  
**SECTION 17, TOWNSHIP 9S, RANGE 15E**  
**ST. TAMMANY PARISH, LA**

**DDG**  
 DUPLANTIS DESIGN GROUP, PC  
 CIVIL ENGINEERING • ARCHITECTURE  
 34 LOUIS PRIMA DRIVE COVINGTON, LA 70433  
 PHONE: 985.626.9547 || FAX: 985.626.0269  
 WWW.DDGPC.COM  
 THIBODAUX | COVINGTON | HOUSTON | BATON ROUGE | HOUMA

DATE: 5-12-15



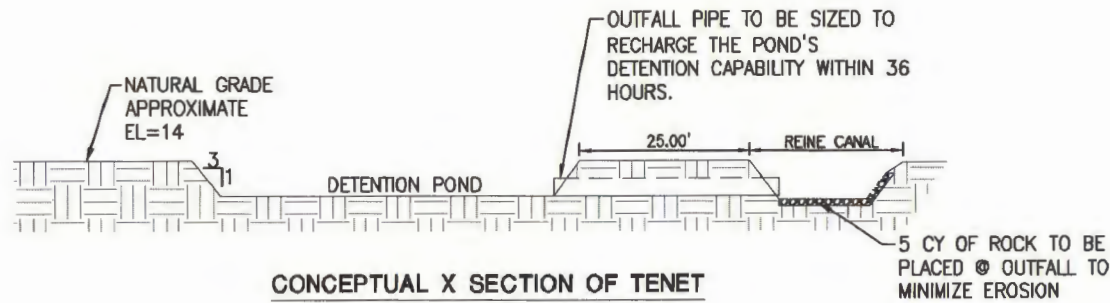

**CONCEPTUAL X SECTION OF TENET POND SHOWING OUTFALL PIPES**  
NTS

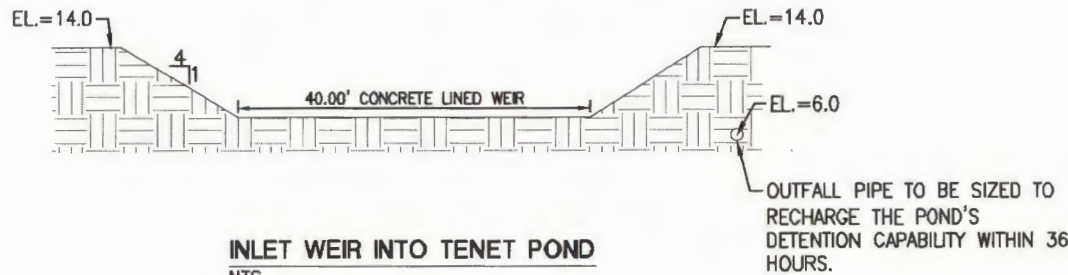

**INLET WEIR INTO TENET POND**  
NTS

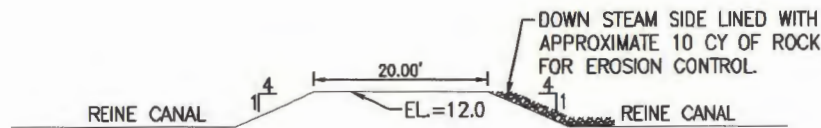

**EARTHEN PLUG IN REINE CANAL**  
NTS

CEMVK-OD-FE KWH-2013-1001

ST. TAMMANY PARISH GOVERNMENT



**DUPLANTIS DESIGN GROUP, PC**  
CIVIL ENGINEERING + ARCHITECTURE

34 LOUIS PRIMA DRIVE COVINGTON, LA 70433  
PHONE: 985.626.9547 || FAX: 985.626.0269

THIBODAUX | COVINGTON | HOUSTON | BATON ROUGE | HOUMA

**15. CROSS SECTIONS  
TENET POND & LOWER FRENCH BRANCH (W-15)  
FRENCH BRANCH (W-15) DRAINAGE PROJECT  
SECTION 17, TOWNSHIP 9S, RANGE 15E  
ST. TAMMANY PARISH, LA**

DATE: 5-12-15